

CONTENTS

WELCOME	2
PLENARY SPEAKERS	4
PRE-CONFERENCES.	8
MAIN CONFERENCE	18
ANNUAL MEETINGS	67
GENERAL INFORMATION	68
SOCIAL PROGRAMME	69
EXHIBITION FAIR	70
INTERNATIONAL SCIENTIFIC COMMITTEE	71
ORGANISERS, SPONSORS AND ECONOMIC SUPPORT	72
MAPS	74



Danish Society of Public Health



- Welfare Development and Health

**4TH EUROPEAN
 PUBLIC HEALTH
 CONFERENCE 2011 COPENHAGEN**



WELCOME



Chairman, local organising committee and president of the Danish Society of Public Health

Dear Participant,

Welcome to Copenhagen, Denmark for the 4th European Public Health Conference which takes place from 9 to 12 November 2011. We look forward to present you an exciting professional programme with high-level plenary speakers, oral sessions, moderated poster sessions, workshops, and exhibitions. We also have more than 20 pre-conferences focusing on a large array of interesting subjects.

We hope Copenhagen 2011 will continue to encourage contacts between researchers and practitioners in the different countries. When the decision was taken to place the conference in Copenhagen, the Danish Society of Public Health felt that we should focus on Public Health and Welfare – Welfare Development and Health. We have a long tradition in the Nordic countries to develop our societies along a welfare tradition. Europe and the world have recently been confronted with an economic crisis and recession. Both in our plenary sessions and parallel programme, we will discuss important questions to the impact of such crises in modern society: Are our societies today robust towards economic crises? Are there differences between the European countries? Which kinds of welfare models are we working with in Europe? Does the impact of social policy and labour market make a difference on the welfare situation of populations?

It is an old saying in public health that the major improvement in health of the population is mainly due to improvements in living conditions (income, housing, work, hygiene, environment etc). Also lifestyle plays an important role. So far the contribution by preventive and curative health services has not been considered especially important. When looking at the growing

elderly population of Europe, there seems to be a change in point of view. Many claim health services to be very important for the elderly population of Europe in order to improve welfare and daily functioning.

New technologies and new drugs have been developed. We therefore wanted an overview where we focus on the contribution of health services to the welfare of the elderly population. Public health training and education plays an important role for the future of professional intervention by public health professionals. We have therefore included a plenary session with a global perspective on this issue.

The planning and conduct of such a large conference as the annual European Public Health Conference cannot take place without the help and involvement of a lot of national and international bodies and persons. I am very grateful to the international and Danish bodies and persons having been involved in the planning. The economic support from the European Commission, from Danish foundations like Trygfonden and Nordea Danmark fonden and from public authorities like the Danish Ministry of Health/The National Board of Health is very important. The core team of planning and conduct of the conference has been Dineke Zeegers Paget and Dorli Kahr-Gottlieb, EUPHA and Torben Jørgensen and Finn Kamper-Jørgensen, The Danish Society of Public Health.

I wish you all a good and interesting conference.

*Finn Kamper-Jørgensen
Chairman, Copenhagen 2011, President, Danish Society of Public Health*

WELCOME



Professor Walter Ricciardi, EUPHA president

As presidents of the European Public Health Association (EUPHA) and the Association of Schools of Public Health in the European Region (ASPHER) we are honored to extend to each of you a warm welcome to the 4th joint European Public Health Conference held in Copenhagen jointly with the Danish Society of Public Health (DSOPH) from 9 to 12 November. The main theme of the conference is Public Health and Welfare – Welfare Development and Public Health.

We are very pleased this year with the high number and high quality of the pre-conferences organized on Wednesday 9 November and Thursday 10 November 2011. As for the conference programme, during plenary sessions we intend to give examples of the mutual relationship between public



Professor Antoine Flahault, ASPHER president

health and welfare. During the parallel programme all aspects of public health are presented, discussed and commented in the 65 oral sessions and 60 moderated poster sessions.

We are pleased to see that the EPH Conference continues to be a platform for European projects to present their results and/or to organize their committee meetings to further the project.

We hope you will enjoy the conference!

*Walter Ricciardi
EUPHA president*

*Antoine Flahault
ASPHER president*

PLENARY SPEAKERS



GÖSTA ESPING-ANDERSEN

Professor of Sociology at the Universitat Pompeu Fabra, Spain, where he directs the DEMOSOC research unit. In 2009 he was nominated ICREA-Academia professor. His scientific work centres on life course dynamics, social stratification and comparative social policy. Before coming to Pompeu Fabra, he taught at Harvard University, the University of Trento and the European University in Italy. Among his major academic publications are numerous books. He has been actively engaged in applied policy relevant work for international organizations, including the United Nations, the OECD, ISSA, and the European Union.



MICHAEL MARMOT

Professor Sir Michael Marmot MBBS, MPH, PhD, FRCP, FFPHM, FMedSci. Director of the International Institute for Society and Health. MRC Research Professor of Epidemiology and Public Health, University College, London. Michael Marmot has led a research group on health inequalities for the past 30 years. He is Principal Investigator of the Whitehall Studies of British civil servants, investigating explanations for the striking inverse social gradient in morbidity and mortality. He leads the English Longitudinal Study of Ageing (ELSA) and is engaged in several international research efforts on the social determinants of health. He chairs the Department of Health Scientific Reference Group on tackling health inequalities. In 2000 he was knighted by Her Majesty The Queen for services to Epidemiology and understanding health inequalities.



ZSUZSANNA JAKAB

The World Health Organization's Regional Director for Europe since 1st February 2010. Before her appointment, she served as the founding Director of the European Centre for Disease Prevention and Control (ECDC) in Stockholm, Sweden. Between 2002 and 2005, Ms Jakab was State Secretary at the Hungarian Ministry of Health, Social and Family Affairs. Prior to that, she spent 11 years at the WHO Regional Office for Europe in Copenhagen, in a range of senior management roles.



JEAN-MARIE ROBINE

Research Director at INSERM, the French National Institute of Health and Medical Research (www.inserm.fr), within the CERMES Research group in Paris (www.cermes3.fr) and the Unit 710 in Montpellier where he heads the research team Biodemography of longevity and vitality. He studies human longevity, with the aim of understanding the relations between health and longevity. In particular, he measures the impact that the increase in adult life durations may have on the health status of the elderly population.



MARTIN MCKEE

Professor of European Public Health at the London School of Hygiene and Tropical Medicine and research director of the European Observatory on Health Systems and Policies. He has published extensively and his achievements have been recognised by, among others, election to learned societies in Europe and the USA, three honorary doctorates and four visiting professorships. He has an active following on Twitter as @martinmckee.



JØRN OLSEN

Jørn Olsen is an MD and PhD and a professor at the School of Public Health, Aarhus University, Denmark as well as professor in residence at the UCLA School of Public Health in Los Angeles, USA. He is head of the Danish Epidemiology Science Centre and the Danish National Birth Cohort. He has been a consultant on epidemiology for the Danish Board of Health. From 2005 to 2008, he was president of the IEA, The International Epidemiology Association, and each year he teaches at the European Summer Course in Epidemiology in Florence, Italy. Jørn Olsen is the author of several textbooks on epidemiology and has written more than 500 peer-reviewed, scientific papers, mainly on reproduction, cancer and research methodology. He is an editor for the International Journal of Epidemiology, and associate editor for Human Reproduction Update.



CAMILLA STOLTENBERG

Deputy Director, Epidemiology and registers, Norwegian National Institute of Public Health, Oslo, Norway.

Camilla Stoltenberg is a MD and epidemiologist. She served as director of the Division of Epidemiology at the Norwegian Institute of Public Health (NIPH) from 2002-2008, and is now deputy director general of the NIPH with responsibility for strategic development of national health registries. She is involved in a number of national and international research infrastructure projects aimed at development of biobanks, health registries and population based cohorts. Her scientific work focuses on autism and other neurodevelopmental disorders, perinatal and genetic epidemiology, health in immigrant populations, and social inequality in health.



OLLE LUNDBERG

Olle Lundberg is Professor of Health Equity Studies, and presently Director of CHES. His main research interests have included welfare research, health inequalities and social determinants of health. His publications cover topics such as the size and trends of health inequalities in Sweden and internationally; welfare trends in Sweden during the crisis in the 1990s; income, relative deprivation and health; the importance of childhood conditions for adult health; Sense of Coherence and its connection to health; and health among older adults.

PLENARY SPEAKERS



ELINA HEMMINKI

Research professor in THL National Institute of Health and Welfare, THL, Finland and adjunct professor in public health in Helsinki and Tampere Universities. She has wide research experience in health services and epidemiological research. Her research interests include use, determinants and consequences of medical technology, particularly in the field of preventive services. Many of her examples come from women's and children's health and drugs (medicines). Her recent work includes studies on maternity care and its technology and postmenopausal hormone therapy. A methodology she is currently interested in is health services trials, and how ethical and governance rules apply to them.



ANTOINE FLAHAULT

Professor, MD, PhD, is dean of the new EHESP School of Public Health. He is professor in epidemiology, at University Paris-Descartes Hôtel Dieu. He has developed with WHO-HQ the global monitoring of influenza (FluNet). His work in research is conducted in a joint unit (UMR-S 707) at Institut National de la Santé et de la Recherche Médicale and University Paris 6 where he is the director of the WHO collaborating centre for electronic disease surveillance. He has written several books (in French) among them one best seller named "A(H1N1), le journal de la pandémie" and supervised a vast exhibition named "EPIDEMIK" in Paris La Cité des Sciences, and moved to Rio de Janeiro and Sao Paulo, Brasil in 2010.



VESNA BJEGOVIC-MIKANOVIC

Professor, MD, MSc and PhD in public health management, is professor at the School of Medicine, Belgrade University. She is a head of the Centre School of Public Health and director of the Institute of Social Medicine. Professor Bjegovic-Mikanovic is responsible for undergraduate education of medical student and postgraduate education of medical doctors and public health professionals. She is involved in different qualitative and quantitative studies related to the topics mentioned above, multilateral research, networking and projects, with published manuscripts in the same field. She is a member of the Executive Board of ASPHER.



KATARYNA M. CZABANOWSKA

MA, PhD, is an assistant professor at the Department of International Health, Faculty of Health, Medicine and Life Sciences, CAPHRI School for Public Health and Primary Care at Maastricht University. Her scientific interests are in the area of Public Health competencies, competences frameworks development, assessment and self-assessment methods, competence-based education, identification of skill gaps between the expectations of job market and taught curricula and innovative educational approaches in the lifelong learning in Public Health which is reflected in her publications and international project experience. Previously she worked at the Institute of Public Health, Jagiellonian University Medical College.



STEPHEN SHORTELL

Dean, School of Public Health, University of California – Berkeley, USA and educated in business administration and behavioural science. He has been editor and chief for health services research and is member of advisory boards in several journals. He has long publication list with a number of books within health care management and has received several awards.



JOSEP FIGUERAS

Director, WHO Europe, European Observatory for Health Systems and Policies.

Josep has collaborated with multilateral organisations such as the European Commission and the World Bank. He is member of advisory and editorial boards and has served as advisor in more than thirty countries within the European region and beyond. He is honorary fellow of the UK faculty of public health medicine, has been awarded twice the EHMA price for the best annual publication on policy and management, and in 2006 he was awarded the Andrija Stampar Medal. He has been lecturer and head of the MSc Health Services Management, London School of Hygiene & Tropical Medicine.



MOGENS LYKKETOFT

President of the Danish Parliament, former Foreign Minister and chairman of the Social Democratic Party.

For three decades Mogens Lykketoft has been the vanguard of Danish politics. He has been a member of the Danish Parliament, Folketinget, since 1981, and is currently the President of the Parliament. He graduated in economics at University of Copenhagen. In the 1970s he was head of the Economic Council of the Labour Movement and the Social Democrats. During 1981-82 he served as Minister of Taxation. Mogens Lykketoft has served as chairman of several parliamentary committees. 1993-2001 he was Minister for Finance, the longest serving in a century, and the chief architect of economic reform. 2000-01 Mr. Lykketoft was Minister of Foreign Affairs, and 2002-05 he was chairman of The Social Democrats.

PRE-CONFERENCES

TIME/LOCATION	ORGANISER	ACTIVITY
8:30 - 18:00 Bella Center B3 M6	EUPHA Section on Social Security and Health	<p>Challenges in comparative, epidemiological studies of sickness absence in Europe - The 9th pre-conference arranged by the EUPHA Section on Social Security and Health</p> <p>Welcome with coffee / tea & surprise!</p> <p>Opening, <i>Kristina Alexanderson, President of the EUPHA section on social security and health</i></p> <p>Introduction to the topic of comparative studies in sickness absence, <i>Ute Bultmann and Angelique de Rijk, The Netherlands</i></p> <p>Experiences with cross country studies on sickness absence, <i>Jan Hogelund, Denmark</i></p> <p>Experiences of other researchers with European cross country studies: results of a pilot inquiry, <i>Ute Bultmann and Angelique de Rijk</i></p> <p>1st discussion in groups: brainstorm and listing considerations in preparing comparative research Moderator: <i>Gunnel Hensing, Sweden</i></p> <p>Funding for comparative research, <i>EU - representative</i></p> <p>Considerations in preparing comparative research: Spanish-Dutch experiences, <i>Fernando Benavides, George Delclos, and David Gimeno, Spain</i></p> <p>2nd group discussion about subthemes in a European guideline for comparative research in sickness absence Following the bartender model, Moderator: <i>Ute Bultmann</i></p> <p>Reports from the bar tenders, Moderator: <i>Ute Bultmann</i></p> <p>Discussion: Summing up of the day & agreements on how to proceed, <i>Angelique de Rijk</i></p> <p>Dinner: For all participants where discussions will continue</p>
9:00 - 17:00 Bella Center B4 M7	EUPHA Section on Child and Adolescent Public Health	<p>Qualitative research methods and dissemination of qualitative interviews studies on patients' experiences via the International DIPEX group</p> <p>Chairs: <i>Sue Ziebland, United Kingdom and Auke Wiegersma, The Netherlands</i></p> <p>Introduction to the pre-conference workshop</p> <p>Section I: Qualitative Research Methods workshop Chair: <i>Auke Wiegersma, The Netherlands</i></p> <p>What are qualitative research methods and why would we use them in health research? <i>Sue Ziebland and Sara Ryan, Oxford, United Kingdom</i> (title to be confirmed) <i>Joyce Lamerichs, The Netherlands</i></p> <p>Researching across and between multiple cultures, <i>Hannah Bradby, United Kingdom</i></p> <p>Section II: Qualitative Research Methods: Presentations of completed DIPEX International websites (Healthtalkonline, DIPEX Germany and DIPEX Spain) Chair: <i>Sue Ziebland, United Kingdom</i></p> <p>Help, demented! Patient and carer speak up? First results, <i>Manna Alma and Griet-Anne Banga, The Netherlands</i></p> <p>"Doctors blame everything on smoking, don't they?": rationalising and resistance amongst smokers, <i>Laura Griffith, United Kingdom</i></p> <p>Discussion and close-up</p>

TIME/LOCATION	ORGANISER	ACTIVITY
9:00 - 17:00 Bella Center B3 M7	French School of Public Health (EHESP)	<p>Management in public health and healthcare organisations – from theory to practice Opening Remarks, <i>Antoine Flahault, Dean of EHESP and President of ASPHER</i> Programme Presentation and Organisation, <i>Stéfane Kabene</i> Issues and Challenges in Management of Health Services Deliveries, <i>John M. Cachia</i> Interprofessional Collaborative Practice Teams and Quality Improvement, <i>Carole Orchard</i> Recruitment and retention of Healthcare Professionals, <i>Stéfane Kabene</i> Cost effectiveness of Healthcare delivery, <i>Laurent Degos, Armelle Leperre-Desplanques</i> Round table 1: Profiling the Manager in Healthcare: Competencies and education Round table 2: Ethical Aspects and Social Accountability of Healthcare Education Concluding Remarks</p>
9:00 - 17:00 Forest Garden Nacadia	Forest & Land- scape, University of Copenhagen	<p>Nature & Public Health Keynote speakers: <i>Ritch Mitchell, United Kingdom</i> <i>Jolanda Maas, The Netherlands</i> <i>Jens Troelsen, Denmark</i></p>
9:00 - 14:00 Bella Center B3 M5	ASPHER	<p>Young Researchers' Forum Body mass index in early adolescence and perceptions regarding overweight and obesity amongst children and their principle caregivers in Peru, <i>Ruchi Baxi</i> Towards Measles Elimination in Europe by 2015: An overview of Measles Epidemiological Situation in Selected European Union Countries and their Strategies of Measles Elimination, <i>Junaid Iqbal Khan</i> Relative inequalities in All Cause and Cause Specific Mortality for Wards in England, <i>Danish Ahmad</i> Are there any future public health professionals among medical students in Croatia? <i>Lucija Murgic</i> The association between tobacco smoking and multidimensional poverty – A case study of Ningxia Province in western China, <i>Jiming Zhu</i> Distinct patterns of association in maternal and paternal grandparents' cardiovascular risk factors, morbidity, all-cause mortality and birth-weight of their grandchildren: Lifeways Cross Generation Cohort Study, Republic of Ireland 2001-2010, <i>Aakash Shrivastava</i> Assessing the impact of removing health service user fees in Sierra Leone, <i>Brieana Dance</i> The All Ireland Traveller Birth Cohort Study (2007-2011): Irish Travellers, maternal health and infant birth weight inequalities, <i>Noor an Hamid</i> LEPHIE – Leaders for European Public Health: Presentation of the Project, <i>Katarzyna Czabanowska</i> Links among physical development of 7 – 8 year old children and socio-demographic inequalities of families in Lithuania (2008 and 2010 survey, <i>Edita Albaviciute</i> Survey of Patient Safety Culture in Selected Slovak Hospitals, <i>Veronika Mikušová</i> Predictors of Post-Surgical Quality of Life in Bariatric Surgery Patients in Jerusalem, Israel, <i>Britt Dash</i> Human health, <i>Jacques Lundja</i> Online Public health education for low and middle-income countries: factors influencing successful student outcomes, <i>Keir Philip</i></p>

TIME/LOCATION	ORGANISER	ACTIVITY
		<p>Measuring Afghan Refugees' Multidimensional Poverty (Health, Education, Accommodation and Income) in five most refugee populated Provinces and a settlement in Iran, <i>Mitra Ahmadinejad</i></p> <p>Design and user management characteristics of latrines associated with fly and larval densities in the Kilombero district of Tanzania, <i>Kristen Knudson</i></p> <p>Multi-source data collection technique in identifying Irish Traveller infant mortality: Findings from the All Ireland Traveller Birth Cohort Study, <i>Noor an Hamid</i></p> <p>Inequity in access to innovative pharmaceutical treatment for patients with rheumatoid arthritis in 41 European countries, <i>Polina Putrik</i></p> <p>Health Policy Agenda-Setting in Tanzania: National and International Stakeholder Perspectives, <i>Sara Fischer</i></p> <p>Awareness of oral rehydration salt (ORS) among mothers of under-five children in Kamala village, West Bengal, India: A cross-sectional study, <i>Kaushik Chattopadhyay</i></p> <p>Epidemiology of childhood Tuberculosis in Berkshire West PCT, <i>Anees Ahmed Abdul Pari</i></p> <p>Adherence to the Mediterranean diet and bone quality in a sample of Portuguese adolescents, <i>Teresa Monjardino</i></p> <p>Do psychosocial factors mediate the association between medicine use and children's migrant background? <i>Lourdes Cantarero-Arévalo</i></p> <p>Literacy Screeners and the European Health Literacy Survey (HLS.EU): Results from Ireland, <i>James Fullam</i></p> <p>Increasing efficiency of HIV prevention policies in risk groups in Bulgaria, <i>Momchil Baev</i></p> <p>Knowledge about the presence of a specific nosological entity and quality of life in subjects with chronic pain, <i>Sara Lourenço</i></p> <p>The Impact of International Medical Travel on Public Health Infrastructures: Asian Country Comparison, <i>Rachael England</i></p>
9:30 - 17:30 Royal Library Copenhagen	Aalborg University, section Music Therapy	<p>Music and public health. The health potential of music in everyday life</p> <p>Welcome address, <i>Lars Ole Bonde, Aalborg University and Center for Music and Health, Oslo.</i></p> <p>Research in music, music therapy, health and wellbeing, <i>Suzanne Hanser, Boston, USA</i></p> <p>Improvisation, Identity and Health, <i>Raymond MacDonald, Scotland</i></p> <p>Singing as a public health resource, <i>Stephen Clift, United Kingdom</i></p> <p>Round table with short presentations by researchers from Center for Music and Health</p> <p>Music therapy in public health partnerships, <i>Brynjulf Stige, Norway</i></p> <p>Music and dementia / prophylactic perspectives, <i>Hanne Mette Ridder, Denmark</i></p> <p>Music and health in everyday life, <i>Lasse Liliestam, Sweden</i></p> <p>Music, emotions and adolescent mental health, <i>Suvi Saarikallio, Finland</i></p> <p>Closing address, <i>Lars Ole Bonde, Denmark</i></p>
10:00 - 17:30 Bella Center B4 M3	EUPHA section on Injury Prevention and Safety Promotion	<p>Health-based injury registration in the Nordic countries and in Europe? Experiences and challenges</p> <p>Welcome, <i>Johan Lund, President of EUPHA section on Injury Prevention and Safety Promotion</i></p> <p>Why is health-based injury registration an issue? Purpose of registration, different models of registration, severity problems, <i>Johan Lund, Norway</i></p> <p>Situation in the five Nordic countries on health-based injury registration. Can they supply a comparable valid national injury picture: fatalities, in/out-patients, general practitioners? <i>Anne Lounamaa, Finland</i></p> <p>Why has it taken so long time to establish valid registration? What are the problems, how to solve them? <i>Jens Lauritsen, Denmark</i></p> <p>Health-based injury registration and classifications in the Nordic countries and in Europe. Status quo and the way ahead <i>Bjarne Laursen, Denmark</i></p>

TIME/LOCATION	ORGANISER	ACTIVITY
		<p>How are preventative authorities using the data, and which data? <i>Thomas Gell, Sweden</i></p> <p>The role of health authorities in establishing valid health based injury registration systems, <i>Jakob Linhave, Norway</i></p> <p>What kind of data do we need for action, centrally and locally? <i>Lucie Laflamme, Sweden</i></p> <p>Discussion, panel and plenary: Lessons to be learned between the Nordic countries and the other countries in Europe</p> <p>Members of the programme committee and Wim Rogmans</p> <p>Conclusions, wrapping up, <i>Johan Lund, Norway</i></p>
<p>10:00 - 18:00 Bella Center B4 M1</p>	<p>EUPHA section on Public Mental Health</p>	<p>Psychosocial determinants of mental health</p> <p>Welcome and introduction, <i>Jutta Lindert, Lena Andersson, Reiner Rugulies</i></p> <p>Work and mental health</p> <p>Psychosocial working conditions and risk of depression. What do we know and what don't we know? <i>Reiner Rugulies</i></p> <p>Work and mental health: the Finnish Public Sector Study, <i>Marianna Virtanen</i></p> <p>Stress and antidepressant medications, <i>Angelo d'Errico</i></p> <p>Social work environment factors and psycho-pharmaceuticals ? Study design and preliminary findings, <i>Ida E.H. Madsen</i></p> <p>Violence and mental health: Abuse of children and mental health in adult life, <i>Jutta Lindert</i></p> <p>Partner violence and mental health, <i>Henrique Barros</i></p> <p>Barriers to mental health care, <i>Lena Andersson</i></p> <p>Discussion, <i>Jutta Lindert, Reiner Rugulies, Lena Andersson</i></p> <p>Well-being and mental health, <i>Claudia Stein</i></p> <p>Policy impact: Psychosocial determinants of mental health and well-being, <i>Jürgen Schefflein</i></p> <p>Wrap-up and outlook for future studies, <i>Jutta Lindert, Reiner Rugulies, Lena Andersson</i></p>
<p>13:00 - 18:00 Bella Center B4 M5</p>	<p>ASPHER Core Competencies</p>	<p>Developing a European Forum for Public Health Competencies & Competencies-based Accreditation System for Public Health Education in Europe</p> <p>Chairs: <i>Antoine Flahault, France, Helmut Brand, The Netherlands</i></p> <p>European PH Core Competencies Programme – update on progress, <i>Christopher Birt, United Kingdom, Anders Foldspang, Denmark</i></p> <p>European Accreditation System for PH Education (APHEA) – presentation and update, <i>Ilana Levin, Antoine Flahault, Josep Figueras</i></p> <p>Invited presentations: Performance of public health professionals, ASPHER WG on Innovation and Good-practice in PH Education, <i>Vesna Bjegovic-Mikanovic</i></p> <p>Public health leadership - innovative competence-based blended learning programme</p> <p>LEPHIE Project, Maastricht University, <i>Katarzyna Czabanowska & Nynke de Jong</i></p> <p>Wrap-up session – conclusions by chairs</p> <p>Joint session with WHO Regional Office for Europe Strengthening Public Health Workforce Capacities in the European Region</p> <p>Chairs: <i>José M Martin-Moreno (WHO Europe)</i></p> <p><i>Antoine Flahault (President, France, ASPHER; Dean, EHESP School of Public Health, Rennes/Paris), Helmut Brand, the Netherlands (President-Elect, ASPHER; Director, SPH, Maastricht University)</i></p>

TIME/LOCATION	ORGANISER	ACTIVITY
13:00 - 17:00 Danish Regions, Copenhagen office	University of Aarhus, School of Public Health	<p>Health technology assessment (HTA) and public health</p> <p>Included presentations: Short introduction to Health Technology Assessment (HTA) including the need for and benefits of HTAs in relation to Welfare Development and Public Health, <i>Ulla Vaeggemose, Katrine Mandrup Tang, Denmark</i> Mini-HTA - a flexible tool assisting professionals and decision makers in e.g. municipal councils, <i>Kristian Kidholm, Denmark</i> How do you identify relevant issues for further examination and analysis relevant for Public Health interventions? <i>Ånen Ringard, Norway</i> Screening - assessing new and existing programmes for early detection or precursors for disease in primary and secondary health care sector, <i>Matejka Rebolj, Denmark</i> Presentation of HTAs related to screening programmes in the perspective of Welfare Development and Public Health <i>Lotte Groth Jensen, Denmark</i> Summing up and outlining the benefits of HTAs in Public Health, <i>Mette Kjoelby, Denmark</i></p>
13:00 - 17:00 Bella Center B3 M8	Johan Macken- bach, Erasmus University Rotter- dam and Martin McKee, LSHTM, London	<p>Successes and failures in health policy</p> <p>Introduction, <i>Johan Mackenbach, the Netherlands (Erasmus MC, Rotterdam)</i> Population health trends in Europe, <i>Martin McKee, United Kingdom (London School of Hygiene and Tropical Medicine)</i> Impact of smoking policies, <i>Anna Gilmore, United Kingdom (University of Bath)</i> Impact of alcohol policies, <i>Peter Anderson, United Kingdom and the Netherlands (Newcastle University and Maastricht University)</i> Impact of road traffic safety policies, <i>Dinesh Sethi, WHO Europe (WHO Regional Office for Europe, Rome)</i> Impact of child health policies, <i>Ingrid Wolfe, United Kingdom (London School of Hygiene and Tropical Medicine)</i> General discussion, <i>Moderated by Martin McKee</i></p>
13:00 - 17:00 Bella Center B3 M5	EUPHA	<p>EUPHA member forum</p> <p>Interactive exchange between all EUPHA members and EUPHA Part 1: EUPHA and its members – interaction, communication and services What has EUPHA done for you in 2011, and what are we planning in 2012, <i>Walter Ricciardi, EUPHA president</i> Country perspective 1 Country perspective 2 Discussion: Part 2. The PHIRE project - a practical example of collaborating with members Introduction to the PHIRE project, <i>Mark McCarthy, EUPHA research lead</i> Panel discussion (with all country work package leaders), <i>Floris Barnhoorn, moderator, Claudia Conceicao, Portugal, Laura Narkauskaite, Lithuania (tbc), Zuzana Katreniakova, Slovakia (tbc), Marvic Sammut, Malta (tbc)</i> Part 3. WHO's health 2020 - starting a public health movement WHO's health 2020 strategy, <i>Agis Tsouros, WHO/Europe, Claudia Stein, WHO/Europe</i> Discussion</p>

TIME/LOCATION	ORGANISER	ACTIVITY
<p>13:00 - 17:00 University of Copenhagen</p>	<p>EUPHA section on Migrant and Ethnic Minority Health</p>	<p>Variations in health status and use of healthcare services between migrants and descendants Welcome and introduction, <i>Allan Krasnik, Denmark</i> Migration and Health: Experiences from Sweden, <i>Kristina Sundquist, Lund University, Sweden</i> Healthcare utilisation patterns in immigrants, their descendants, and ethnic Danes, <i>Signe Smith Nielsen</i> The role of young adult migrants in stimulating participation in breast cancer screening among their mothers and other female family members, <i>Karen Hosper</i> Migrant background, feeling safe at school, and medicine use for common health problems among adolescents: a national cross-sectional survey, <i>Lourdes Cantarero-Arévalo</i> A life course perspective of migration and health and resulting challenges, <i>Jacob Spallek</i> Choice, chance and context: shaping generational differences in ethnic inequalities in health, <i>Neil Smith, United Kingdom</i> Informal dinner at Nørrebro Bryghus</p>

TIME/LOCATION	ORGANISER	ACTIVITY
8:00 - 11:45 Bella Center B4 M3	Swedish National Institute of Public Health	<p>Monitoring public health trends and public health policies in the 21st century</p> <p>Introduction to the issue, <i>Sarah Wamala</i> Keynote speaker, <i>Bo Burström</i> Current public health monitoring methods of regional members: Sweden, Nordic country agency representatives, and the Netherlands (each 15-20 minutes)</p> <ol style="list-style-type: none"> 1. What is followed in terms of public health policy e.g. national indicators, and who has the responsibility? 2. How are these followed e.g. national statistics, research summaries? 3. How are these reported e.g. national public health policy report? 4. How are these received by the political apparatus, and how do they affect policy changes? <p>Open panel discussion on methods to address public health trends and public health policies today and tomorrow - identifying challenges and opportunities</p>
9:00 - 11:15 Bella Center B3 M5	Steno Health Promotion Center, Steno Diabetes Center	<p>High-level meeting of the United Nations General Assembly on the Prevention and control of noncommunicable diseases - a critical European perspective</p> <p>Action plan for implementation of the European Strategy for the Prevention and Control of Noncommunicable Diseases (2012-2016) - the guiding principles, vision and action areas, <i>Gauden Galea, WHO Europe, Director, Division of NCD and HP, WHO Regional Office for Europe</i> Addressing social determinants of NCDs, <i>Michael Marmot, United Kingdom, University College London</i> Promoting health and preventing disease, <i>Bjarne Bruun Jensen, Denmark, Steno Health Promotion Center, Steno Diabetes Center</i> Research needs for effective action to prevent NCDs, <i>Maximilian de Courten, Denmark, Copenhagen School of Global Health, University of Copenhagen</i> The role of the private sector in implementing solutions, <i>Stig Pramming, Pramming Consult</i> Plenary discussion (Key questions to be developed after UNGASS meeting)</p>
9:00 - 14:00 Bella Center B4 M5	City of Copen- hagen	<p>Lifestyle changes in deprived areas - emphasizing tobacco prevention</p> <p>Welcome and brief introduction, <i>Anne Smetana, Denmark</i> <i>Mads Lind, Denmark</i> Mapping social inequalities in health and implementation of strategies in Copenhagen, <i>Finn Diderichsen, Denmark</i> Local tobacco prevention and how to narrow the gap, <i>Amanda os, United Kingdom</i> Developing a tobacco prevention programme in a local community in Copenhagen <i>Birgitte Gade Koefoed, Denmark</i></p>
10:00 - 14:00 Bella Center B3 M7	ECDC	<p>How financial difficulties shape social determinants on communicable diseases</p> <p>Welcome and brief introduction from ECDC, <i>Karl Ekdahl, ECDC</i> Socio-economic determinants and infectious diseases - what ECDC is working on, <i>Ulla-Karin Nurm, ECDC</i> Financial crisis and infectious diseases: what are the links? <i>David Stuckler, United Kingdom, University of Cambridge, London School of Hygiene & Tropical Medicine</i> Socio-economic determinants and measles outbreak in Bulgaria, <i>Svetla Tsolova, ECDC</i> The puzzling impacts of urbanisation on TB, <i>Tek-Ang Lim, ECDC</i> Panel discussion: Challenges in tackling social factors that affect health Panel members: <i>David Stuckler, Ulla-Karin Nurm, Svetla Tsolova, Tek-Ang Lim</i> Moderator: <i>Martin McKee, United Kingdom, London School of Hygiene & Tropical Medicine</i> Closing remarks, <i>Karl Ekdahl, ECDC</i></p>

TIME/LOCATION	ORGANISER	ACTIVITY
<p>10:00 - 11:30 Bella Center B3 M6</p>	<p>EUPHA with an unrestricted grant from Sanofi Pasteur MSD</p>	<p>Round table: Advancing health and welfare through vaccination. Benefits and challenges of routinising vaccines Chair: <i>Ruth Gelletlie, president of the EUPHA section on Infectious Diseases Control</i> Introductory remarks The health and welfare consequences of low measles vaccination uptake in Europe, <i>M Muscat, Denmark</i> The health and welfare impact of HPV diseases, <i>GL Mortensen, Denmark</i> New communication approaches to improve social acceptance, <i>Speaker tbc</i> Latest EU Council recommendations on childhood immunisation: what is the expected impact on EU public health <i>PL Lopalco, ECDC</i> Q&A session Moderator: <i>Ruth Gelletlie</i></p>

ROUND TABLE DISCUSSION

”Advancing health and welfare through vaccination Benefits and Challenges of routinizing vaccines”

10 November 2011, 10:00-11:30, Copenhagen

Organised by EUPHA, supported by an unrestricted grant from Sanofi Pasteur MSD

Vaccination coverage in a population is an indicator of sustainable development. Vaccines do not only prevent diseases and their complications, they also help avoid or reduce their social, psychological and economic outcomes: hospitalisations, pain, distress, sickness absence, child care. Senior vaccination contributes to healthy and active ageing. Reduction of vaccine preventable diseases improves the functioning of hospitals, day care centres, education and business.

Yet many recommended vaccines remain underused with important health consequences and societal costs. Since the beginning of 2011 there has been a worrying resurgence in cases of measles in 24 European countries, with in some areas five times more cases than in 2010. Many outbreaks and hospitalisations have been reported, particularly in France, Spain, Switzerland, Belgium, the UK and Germany. Though measles vaccination has been recommended for many years in these countries, the overwhelming majority of cases were non-vaccinated subjects. This situation illustrates the challenges of routinizing vaccines:

- How to better inform the lay public and change attitudes?
- How should governments promote their health policy to increase vaccination uptake?
- How to improve access to and opportunities for prevention?

The objectives of this roundtable are to

- remind the public health impact and societal costs of suboptimal coverages of recommended vaccinations (eg measles, flu, pertussis, HPV)
- show the individual and collective benefits of routine vaccination in terms of both health and welfare (eg psychosocial burden, societal consequences of disease);
- better understand the main barriers and drivers, and explore innovative ways to improve the acceptance, access to and effective implementation of vaccination, using good practices, better cooperation and insights from social sciences

The speakers of the round table will try to answer these questions and propose relevant approaches and practical actions. This will be illustrated by measles and HPV vaccination. The audience will have the opportunity to ask questions to the panellists and open a debate.

The expected outcome of this session is to provide the participants with data, arguments and guidance to improve the routinization of vaccines and help maximize the benefits of vaccination for individuals and society's benefit.

"Advancing health and welfare through vaccination Benefits and challenges of routinizing vaccines"

10:00 - 10:10	<p>Session I: Introductory remarks</p> <p>Suggestion: eg Historical perspective on health and welfare improvements provided by vaccination. Today's challenges.</p>	<p>Chair: Ruth Gelletlie, EUPHA Infectious Disease Section and Health Protection Agency, Director of Emergency Preparedness and Response,</p>
10:10 - 10:25	<p>1. The health and welfare consequences of low measles vaccination uptake in Europe</p> <p>Public health impact and societal consequences of non-vaccination. Identification of main barriers.</p>	<p>M. Muscat, European Surveillance Network, Statens Serum Institute (Denmark)</p>
10:25 - 10:40	<p>2. The health and welfare impact of HPV diseases</p> <p>HPV psychosocial burden, the health and welfare benefits of vaccination as well as drivers and barriers to HPV vaccination</p>	<p>GL Mortensen, HPV specialist (Denmark)</p>
10:40 - 10:55	<p>3. New communication approaches to improve social acceptance</p> <p>How social sciences and new communication approaches can help understand both the challenges and drivers to vaccination. How they can provide authorities, healthcare professionals and the public health community with new methods, communication and implementation approaches.</p>	
10:55 - 11:15	<p>4. Latest EU Council recommendations on childhood immunisation: what is the expected impact on EU public health</p>	<p>PL Lopalco, European Center on Disease Control and Prevention, Scientific Advice Unit</p>
11:15 - 11:30	<p>Q&A session</p> <p>The objective is to open the debate with the audience</p>	<p>Moderator: Ruth Gelletlie</p>

MAIN CONFERENCE



Welfare and public health
The Øresund Bridge



Chronic diseases
The Immervad Bridge



Migrant and ethnic minority health
The Limfjord Bridge



European public health
The Storebælt Bridge



Public health research and innovation
The new Lillebælt Bridge



Child and adolescent public health
The Oddesund Bridge



Health services & systems
King Hans' Bridge



Benefits and reliability of data collection
The Karrebæksminde Bridge "The grasshopper"



Lifestyle
The Vilsund Bridge



Consumers and patients
The Langeland Bridge



Public health competencies
The Farø Bridges



Health promotion 1
The Svendborgsund Bridge



Public health policy
Munkholm Bridge



All inclusive public health
The Aggersund Bridge



Health promotion 2
The Virksund Bridge



Inequalities
Knippelsbro



News in public health
The Guldborgsund Bridge



Public mental health
The Sallingsund Bridge



Sickness absence
The Lillebælt Bridge



Interesting health poster
Queen Alexandrine's Bridge

TIME/LOCATION	TRACK	ORGANISER	ACTIVITY
12:00- 13:00 Aud. 10-11-12			Opening ceremony Welcome by: <i>Finn Kamper-Jørgensen, chair of Copenhagen 2011</i> <i>Walter Ricciardi, president of EUPHA</i> <i>Antoine Flahault, president of ASPHER</i>
13:00- 13:45 Aud. 10-11-12			Plenary 1 Chair: <i>Finn Kamper-Jørgensen, Denmark</i> Rival welfare state models and their impact on family and child welfare, <i>Gosta Esping-Andersen, Spain</i>
Oral sessions			
14:00- 15:30 Aud. 10-11-12	Welfare and public health	The INPES Research Chair in Health Promotion	1A. Skills building seminar - Inequalities in health: disentangling the processes, and setting the scene for public health action Chairs: <i>Eric Breton and William Sherlaw, France</i> How do public health programmes increase inequalities in health and how to prevent this from happening? <i>Eric Breton, France</i> Questions of agency, <i>William Sherlaw, France</i> Applying theories of social justice to develop 'iniquity-proof' disease prevention-health promotion programmes, <i>Eric Breton, France</i>
14:00- 15:30 Room 16	European public health	European Commission	1B. Promoting innovation and quality in health: reshaping healthcare as a promoter to welfare development in EU Member States (EU1) Chairs: <i>Georgios Margetidis, Guy Dargent, European Commission</i> The EU Health Programme – an introduction on behalf of EAHC, <i>Georgios Margetidis, European Commission</i> The Joint Action on Health Technology Assessment (JA HTA) – Health Technology Assessment as an effective and innovative way of promoting welfare advancement, <i>Finn Børlum Kristensen</i> EUROREGIO III - Health systems at a tipping point: progress or regression, <i>Jonathan Watson</i> European Reference Networks (ERNs) for highly specialised care: using the experience of the Rare Disease pilot networks as a way forward, <i>Segolene Ayme</i> Health Care Quality Indicators: moving to the next level, <i>Vladimir Stevanovic</i>
14:00- 15:30 Room 17	Health services and systems	EUPHA Section on Public Health Genomics	1C. Workshop: The Future of Healthcare Chairs: <i>Angela Brand, The Netherlands and Peter Boyle, France</i> Genome-based innovations in healthcare - challenges for prevention, <i>Peter Boyle, France</i> The IT Future of Medicine - a flagship initiative to revolutionize our healthcare system, <i>Hans Lehrach, Germany</i> Valorisation of genome-based technologies in public health, <i>Jonathan Lal, The Netherlands</i> From idea to practice: Issues to be solved by personal medicine on the way to clinical practice and healthcare, <i>Hans-Peter Dauben, Germany</i>

TIME/LOCATION	TRACK	ORGANISER	ACTIVITY
14:00- 15:30 Room 18	Consumers and patients		<p>1D. Patients in the centre?</p> <p>Chairs: <i>Diana Delnoij, The Netherlands, Ingrid Willaing, Denmark</i></p> <p>Online learning tools in evidence-based practice: changes in skills across cultures, <i>Molly Ferguson, United States</i></p> <p>Macro-level determinants of health among adolescents in welfare states: a multi-level analysis, <i>Katharina Rathmann, Germany</i></p> <p>A comparative study of educational differences in disability-free life expectancy in nine European countries in the 21st century, <i>Netta Mäki, Finland</i></p> <p>Healthcare utilisation among the Belgian elderly in relation to their socioeconomic status, <i>Sarah Hoeck, Belgium</i></p> <p>Patient preferences in patient education for patients with type 2 diabetes, <i>Ingrid Willaing, Denmark</i></p> <p>Factors associated with adherence levels in kidney transplant recipients, <i>Lucia Prihodova, Slovakia</i></p>
14:00- 15:30 Room 19	Public health policy	REPOPA consortium and EIRA network	<p>1E. Workshop: Research into Policy in Physical Activity - which theories and methods are applicable?</p> <p>Chairs: <i>Arja R. Aro, Denmark and Nancy Edwards, Canada</i></p> <p>The main theories in guiding evidence-informed policy development and evaluation: towards a meta-framework, <i>Arja R. Aro, Denmark</i></p> <p>Dissemination and translation of research on the policy for physical activity in Finland: good intentions need a proper implementation framework, <i>Timo Stahl, Finland</i></p> <p>Collaborative decision making across sectors and organisations: can gaming simulation help? <i>Ien van de Goor, The Netherlands</i></p> <p>Online Training for Evidence-Based Behavioral Practice (EBBP): Introduction and Evaluation Across Cultures, <i>Molly Ferguson, United States</i></p>
14:00- 15:30 Room 20	Inequalities		<p>1F. Regional health differences</p> <p>Chairs: <i>Helmut Brand, The Netherlands and Finn Breinholt, Denmark</i></p> <p>Traffic risks by travel mode in the metropolitan regions of Stockholm and San Francisco: A comparison of safety indicators, <i>Carolyn McAndrews, United States</i></p> <p>Excess costs due to selected chronic diseases among citizens of Copenhagen in 2007 <i>Ane Bonnerup Vind, Denmark</i></p> <p>Partnership for sustainable welfare development in four Swedish cities 2003-2009 <i>Karin Fröding, Sweden</i></p> <p>Lifestyle factors and socioeconomic gradients in coronary heart disease in the 2003 Scottish Health Survey cohort, <i>Lindsay Gray, United Kingdom</i></p> <p>Health in depopulating regions in the Netherlands, <i>Antonia Verweij, The Netherlands</i></p> <p>Relation between high caesarean section rate and health insurance coverage in rural China <i>Qian Long, Finland</i></p>

TIME/LOCATION	TRACK	ORGANISER	ACTIVITY
14:00- 15:30 Room BV1	Sickness absence		<p>1G. Sickness absence certification</p> <p>Chairs: <i>Gunnel Hensing, Sweden, Chris Jensen, Denmark</i></p> <p>Physical Activity, Sickness Absence and Self-rated Health among Norwegian Doctors, <i>Judith Rosta, Gunnar Tellnes, Norway</i></p> <p>Motives for early retirement of self-employed GPs in the Netherlands: a comparative study of two periods, <i>Malou van Greuningen, The Netherlands</i></p> <p>Physicians' sickness certification practices: a systematic review, <i>Kristina Alexanderson, Sweden</i></p> <p>What physicians need in order to ensure high quality in managing sickness certification cases <i>Christina Lindholm, Sweden</i></p> <p>Strong to Work - ill and resilient in primary care. Evaluation of a Dutch project on care innovation. <i>Nathalie Donders, The Netherlands</i></p> <p>Influences of guidelines on crucial information in sickness certificates classified according to the International Classification of Functioning, Disability and Health. A comparative study of sickness certificates in Sweden, <i>Emma Nilsing, Sweden</i></p>
14:00- 15:30 Room BV2	Chronic diseases	WHO/EURO Division of Noncommunica- ble Diseases and Health Promotion & EUPHA section on Chronic Diseases	<p>1H. Workshop: The year of noncommunicable diseases: implications of the global movement for the European region</p> <p>Chairs: <i>Gauden Galea, WHO Europe, Iveta Nagyova, Slovakia</i></p> <p>The New European Health Policy: Links with the emerging global NCD movement, <i>Zsuzsanna Jakab, WHO Europe</i></p> <p>The year since Oslo: The emergence of a global movement, <i>Bjorn-Inge Larsen, Norway</i></p> <p>The Year of Noncommunicable Diseases from an EC perspective, <i>Michael Hubel, European Commission</i></p> <p>Challenges and opportunities for EUPHA to take action to fight NCDs, <i>Iveta Nagyova, EUPHA section on Chronic Diseases</i></p>
14:00- 15:30 Room B3 M5	Public health research and innovation	EUPHA section on Public Health Epidemiology	<p>1I. Workshop: The introduction of new vaccines at the European level: challenges to optimise immunisation policies</p> <p>Chair: <i>Giuseppe La Torre, Italy</i></p> <p>National Health Technology Assessments in EU/EEA countries for the introduction of new vaccines. The example of pneumococcal vaccination from a VENICE survey, <i>Paolo Fortunato D'Arcona, Italy</i></p> <p>Improving the introduction (and implementation) of new vaccines in EU countries to maximise Public Health benefits - an Industry perspective, <i>Magdalena de Azero, EVM</i></p> <p>Panel Discussion</p>
14:00- 15:30 Room B3 M6	Benefits and reliability of data collection	EUPHA section on Urban Health	<p>1K. Workshop: How to collect data to improve the health of European citizens living in urban areas</p> <p>Chairs: <i>Arpana Verma, United Kingdom, Erik van Ameijden, The Netherlands and Chris Birt, United Kingdom</i></p> <p>EURO-URHIS 2: Collecting data for urban areas, <i>Erik van Ameijden, The Netherlands</i></p> <p>EURO-URHIS 2: Collecting existing data for urban areas, <i>Laurens van Buren, The Netherlands</i></p> <p>EURO-URHIS 2: Collecting adult data for urban areas, <i>Elisa Puzzolo, Italy</i></p> <p>EURO-URHIS 2: Collecting adult data for urban areas, <i>Joyeeta Guha</i></p>

TIME/LOCATION	TRACK	ORGANISER	ACTIVITY
14:00- 15:30 Room B3 M7	Public health competencies		<p>1L. Competencies in health</p> <p>Chairs: <i>Fred Paccaud, Switzerland, Ingelise Andersen, Denmark</i></p> <p>Distinct associations in grandparents' morbidity, mortality and birth-weight of their grandchildren: Lifeways Cross Generation Cohort Study, Republic of Ireland 2001-2010, <i>Aakash Shrivastava, Ireland</i></p> <p>Enhancing resilience and disaster preparedness through community development and the social determinants of health, The EnRICH Project, Canada, 2009-2013, <i>Tracey O'Sullivan, Canada</i></p> <p>Sleep duration in European children - differences and determinants, <i>Sabrina Hense, Germany</i></p> <p>Sex differences in coverage of influenza vaccinations in subjects with diabetes mellitus and ischemic heart disease: trends over two decades, <i>Thomas E. Dorner, Austria</i></p> <p>Gender differences in health-related quality of life using the EQ-5D instrument - a follow-up study in central Sweden, <i>Anders Berglund, Sweden</i></p> <p>Differences in diagnoses between non-western immigrants and native Dutch in GP practices: interaction with deprivation, <i>Walter Devillé, The Netherlands</i></p>
14:00- 15:30 Room B3 M8	All inclusive public health		<p>1M. Women and health 1</p> <p>Chairs: <i>Carmen Aceijas, United Kingdom, Kirsten Vinther-Jensen, Denmark</i></p> <p>Factors affecting the use of prenatal and postnatal care by women of non-western immigrant origin in industrialised western countries, <i>Agatha Boerleider, The Netherlands</i></p> <p>Maternity outcomes amongst Polish migrants in Scotland - compared to Scottish and Polish data <i>Dermot Gorman, United Kingdom</i></p> <p>Induced abortions in the European Union, <i>Mika Gissler, Finland</i></p> <p>Deciding treatment for miscarriage in first trimester - experiences of women and health care professionals, <i>Mette Linnet Olesen, Denmark</i></p> <p>Relative risk of stillbirth among women of different regions of origin compared to German women: an analysis of the German perinatal database, 2004-2007, <i>Anna Reeske, Germany</i></p> <p>Knowledge and attitudes of medical students and students of social work about violence against women in partnership, <i>Gordana Pavlekovic, Croatia</i></p>
14:00- 15:30 Room B4 M1	News in public health	EUPHA section on Public Health Epidemiology	<p>1N. Tobacco use: a never ending story?</p> <p>Chairs: <i>Thomas Abel, Switzerland, Charlotta Pisinger, Denmark</i></p> <p>Conceiving of the end of tobacco use, <i>George Thomson, New Zealand</i></p> <p>Looking at the smoking epidemic through the lens of population pyramids: Italy, 1983-2005 <i>Bruno Federico, Italy</i></p> <p>Cannabis, schizophrenia and other psychoses: 37 years follow-up of a population-based cohort <i>Edison Manrique, Sweden</i></p> <p>Children's exposure to environmental tobacco smoke in the Capital Region of Denmark, from 2007 to 2010, <i>Charlotta Pisinger, Denmark</i></p> <p>Is the workplace an effective platform for recruiting to smoking cessation classes? <i>Jo Coolidge, Denmark</i></p> <p>The changing contribution of smoking to educational differences in life expectancy: estimates for Finnish men and women from 1971 to 2005, <i>Pekka Martikainen, Finland</i></p>
15.30 - 16.15 Room BV2			Annual meeting of the EUPHA section on Public Health Epidemiology

TIME/LOCATION	TRACK	ORGANISER	ACTIVITY
Moderated poster sessions			
16:00 - 17:00 Poster Area	Welfare and public health	EUPHA section on Urban Public Health	<p>2A. Urban Health Chair: <i>Charlotte Glümer, Denmark</i></p> <p>2A.1 Associations between availability of public transport and commuting physical activity <i>Sune Djurhuus, Denmark</i></p> <p>2A.2 Are area-level and individual-level socioeconomic factors associated with self-perceived health in adult urban citizens? <i>Martina Behanova, Slovakia</i></p> <p>2A.3 Degree of urbanisation and substance use among Slovak adolescent boys and girls in 2010 <i>Lukas Pitel, Slovakia</i></p> <p>2A.4 Urban-rural differences in parental knowledge of factors influencing oral health of Russian pre-school children, <i>Mikhail Pastbin, Russia</i></p> <p>2A.5 Comparison of cardiovascular drugs consumption between the city of Zagreb and Lika-Senja County, <i>Danijela Stimac, Croatia</i></p> <p>2A.6 Small geographical areas to use in contextual related health research - does the size matter? <i>Rikke Lynge Storgaard, Denmark</i></p> <p>2A.7 Socioeconomic and environmental factors are the main determinants of regional differences in cardiovascular mortality in Poland – an ecological analysis, <i>Grazyna Broda, Poland</i></p>
16:00 - 17:00 Poster Area	European public health	University of Maastricht	<p>2B. Poster workshop: Policy and Organisational Innovation for Cross-Border Care in Europe Chair: <i>Matt Commers, The Netherlands</i></p> <p>2B.1 EurSafety Health-net: Euregional Dutch-German Quality Network for Patient Safety and Infection Protection, <i>Jan Mueller, The Netherlands</i></p> <p>2B.2 Legal challenges in cross-border cooperation - Experiences from the Euregio II Project, <i>Ingeborg van der Molen, The Netherlands</i></p> <p>2B.3 Toward a European University Hospital Aachen-Maastricht: Implications of Cross-Border Joint Hospital Programmes, <i>Saskia Knies, The Netherlands</i></p>
16:00 - 17:00 Poster Area	Health services and systems		<p>2C. Primary care Chair: <i>Camilla Palmhøj Nielsen, Denmark</i></p> <p>2C.1 The development of GP and patient questionnaires for QUALICOPC, a European study on primary care, <i>Willemijn Schäfer, The Netherlands</i></p> <p>2C.2 Data automatically extracted from the electronic health record in general practice in Belgium: usable for quality of care research? <i>Viviane Van Casteren, Belgium</i></p> <p>2C.3 Improving Primary Health Care Services and Organizational Culture through human resources development, <i>Claudia Leone, Portugal</i></p> <p>2C.4 Considerations made by the general practitioner when dealing with sick-listing of patients suffering from subjective and composite health complaints, <i>Stein Nilsen, Norway</i></p> <p>2C.5 Multidisciplinary collaboration: a successful factor for Primary Health Care. The case of the Italian Health Districts, <i>Gianfranco Damiani, Italy</i></p> <p>2C.6 The impact of implementing the Family Health Units in the practices of professionals in Portugal, <i>Helio Oliveira, Portugal</i></p> <p>2C.7 The integration of family services: The viewpoint of managers of the municipal sphere of authorities, <i>Marja-Leena Perälä, Finland</i></p> <p>2C.8 Institutional elderly patient intake: a systematic review of community-based models of integrated care, <i>Modesta Visca, Italy</i></p> <p>2C.9 Public authority over home care, <i>Nadine Genet, The Netherlands</i></p>

TIME/LOCATION	TRACK	ORGANISER	ACTIVITY
16:00 - 17:00 Poster Area	Consumers and patients	NIVEL - Netherlands Institute for Health Services Research	<p>2D. Poster workshop: European experiences with the Patient Activation Measure (PAM) Chair: <i>Jany Rademakers, The Netherlands</i></p> <p>2D.1 Measurement of activation across self management programmes, <i>Aslakk Steinsbekk, Norway</i> 2D.2 Effects on patient activation and health behaviour after the -Ready to Act- intervention targeted people with screen-detected prediabetes and T2-diabetes in primary care, <i>Helle Terkildsen Maindal, Denmark</i> 2 D.3 PAM in the Netherlands: activation level of diabetic patients and the relation with quality of health care, <i>Michelle Hendriks, The Netherlands</i></p>
16:00 - 17:00 Poster Area	Public health policy		<p>2E. Ethics and values in public health Chair: <i>Els Maeckelberghe, The Netherlands</i></p> <p>2E.1 Values in public health: What a sample of Italians think about solidarity, individual responsibility and health care funding, <i>Umberto Gelatti, Italy</i> 2E.2 Rethinking 'culture' in cultural competence, <i>Judith Sim, United Kingdom</i> 2E.3 Culturally sensitive translations of patient information leaflets: lessons from a study of pregnancy screening information with Chinese, Urdu and Polish speakers, <i>Douglas Mackenzie, United Kingdom</i> 2E.4 Equity to Health Care Resources Access. A Longitudinal Analysis of Strokes in Spain: Multilevel Approach, <i>Borja Garcia, Spain</i> 2E.5 Dependence of health care accessibility and quality on informal payments by patients <i>Nadia Veleva, Bulgaria</i> 2E.6 Economic hardship and depression in Europe: the role of attitudes towards state responsibility in different welfare state regimes, <i>Katia Levecque, Belgium</i> 2E.7 Health-conscious behaviour of health care college students in Hungary, <i>Andrea Lukács, Hungary</i> 2E.8 Nature-Culture-Health Activities (NaCuHeal): Better Public Health by volunteers' work in Norway <i>Bitt-May Wickstrøm, Norway</i> 2E.9 Public health research in the medical ethics committees in Finland, <i>Jorma Virtanen, Finland</i></p>
16:00 - 17:00 Poster Area	Inequalities		<p>2F. Social inequalities in children and adolescents Chair: <i>Bjørn Holstein, Denmark</i></p> <p>2F.1 Social inequality in child and youth health, well-being and behavior, <i>Anne Sophie Gottlieb, Denmark</i> 2F.2 The impact of shared family factors on the educational gradient in cause specific mortality among adults, <i>Oyvind Naess, Norway</i> 2F.3 Infant Mortality Disparities: Peer Education Strategies for Infant Mortality Awareness and Prevention, <i>Isabel Estrada Portales, United States</i> 2F.4 Social determinants of mortality after leaving parental home - effects of childhood and current sociodemographic factors, <i>Hanna Remes, Finland</i> 2F.5 Early childhood care in community health promotion and prevention - evaluation of approaches, methods and projects in a disadvantaged urban quarter, <i>Waldemar Suess, Germany</i> 2F.6 Infants and toddlers preventive health services utilisation among Jews and Arab children in Israel <i>Nadav Davidovitch, Israel</i> 2F.7 Uptake of child health services among low income and immigrant families in a Swedish county 1998-2008, <i>Thomas Wallby, Sweden</i></p>

TIME/LOCATION	TRACK	ORGANISER	ACTIVITY
16:00 - 17:00 Poster Area	Sickness absence		<p>2G. Sickness absence 1</p> <p>Chair: <i>Ellenor Mittendorfer Rutz, Sweden</i></p> <p>2G.1 A comparative study on sickness absence rates and patterns in Norway and Denmark <i>Line Krane, Norway</i></p> <p>2G.2 The role of lifestyle, health, and work in educational inequalities in sick leave and productivity loss at work, <i>Suzan Robroek, The Netherlands</i></p> <p>2G.3 Incidence of disability pension and associations with sociodemographic factors in a Swedish twin cohort, <i>Åsa Samuelsson, Sweden</i></p> <p>2G.4 Potential years of working life lost due to permanent disability in a cohort of Social Security affiliated workers in Spain, 2004 - 2009, <i>Xavier Duran, Spain</i></p> <p>2G.5 The work ability index and single-item question: associations with sick leave, symptoms, and health - a prospective study of women on long-term sick leave, <i>Linda Ahlstrom, Sweden</i></p> <p>2G.6 Does sickness absence necessitate certification by a medical physician? <i>Torunn Skåltveit Olsen, Norway</i></p> <p>2G.7 Why are general practitioners reluctant to enrol patients into a randomised controlled trail on sick leave? A qualitative study, <i>Silje Maeland, Norway</i></p> <p>2G.8 Return to work - is job change the option for some groups? <i>Kerstin Ekberg, Sweden</i></p> <p>2G.9 Strong support for work place transfer - a cross sectional study of attitudes to sickness insurance regulations in Sweden, 2008, <i>Kristina Holmgren, Sweden</i></p>
16:00 - 17:00 Poster Area	Chronic diseases		<p>2H. Chronic disease management</p> <p>Chair: <i>Walter Ricciardi, Italy</i></p> <p>2H.1 An assessment model for regional disease management programmes in Denmark <i>Kristina Johansen, Denmark</i></p> <p>2H.2 Multivariate analysis of rehabilitation effects in COPD patients, <i>Ramune Jacobsen, Denmark</i></p> <p>2H.3 How an active implementation of a chronic disease management programme influences patients assessment of the care they receive. Ringkoebing-Skjern Municipality in Denmark, <i>Margrethe Smidth, Denmark</i></p> <p>2H.4 What chronically ill patients want from the GPs: A stated-preference approach of the Chronic Care Model, <i>Krucien Nicolas, France</i></p> <p>2H.5 Value of octocog alfa (Advate) in the management of Haemophilia A patients, <i>Flavia Kheiraoui, Italy</i></p> <p>2H.6 Clinical Routine Rehabilitation of patients with Chronic Obstructive Pulmonary Disease, <i>Bodil Bjørnshave, Denmark</i></p> <p>2H.7 Programme for treatment of patients with heart failure at home - evaluation of the therapeutic outcomes and effectiveness: a randomized controlled trial, <i>Nadia Veleva, Bulgaria</i></p> <p>2H.8 Evaluation of The Chronic Disease Self-Management Program in Denmark, <i>Anders Brogaard Marthedal, Denmark</i></p>

TIME/LOCATION	TRACK	ORGANISER	ACTIVITY
16:00 - 17:00 Poster Area	Public health research and innovation		<p>2I. Health services 1 Chair: <i>Judith de Jong, The Netherlands</i></p> <p>2I.1 The effect of healthcare reforms on patients mobility in Italy, <i>Gabriele Messina, Italy</i></p> <p>2I.2 GP-income development in relation to recent health care reforms: an international comparison, <i>Jouke Van der Zee, The Netherlands</i></p> <p>2I.3 Improving the reimbursement of health care provided by Spain to European citizens, <i>Inés García-Sánchez, Spain</i></p> <p>2I.4 Prevalence, awareness, treatment and control of hypertension among the Ghanaian population in Amsterdam, the Netherlands - the GHAIA study, <i>Charles Agyemang, The Netherlands</i></p> <p>2I.5 Impact of the family's functionality and information on therapeutic adherence after ischemic heart disease, <i>Antonio Dias, Portugal</i></p> <p>2I.6 The Project "One Year Together" to Evaluative Units of Alzheimer (EUA) "Dottore Angelico" Aquino (FR)_Lazio Regione- Italy, <i>Elisabetta de Vito, Italy</i></p> <p>2I.7 Access to health care system of patients with acute coronary syndrome according to gender, <i>José Luis Navarro Espigares, Spain</i></p>
16:00 - 17:00 Poster Area	Benefits and reliability of data collection	Section Environ- ment Related Diseases	<p>2K. Poster workshop: Human biomarkers in support of environmental health research and policy Chair: <i>Ludwine Casteleyn, Belgium</i></p> <p>2K.1 Trends in biomarkers research and their potential for biomonitoring strategies <i>Lisbeth Knudsen, Denmark</i></p> <p>2K.2 Human Biomonitoring in WHO and EU, <i>Pierre Biot, Belgium</i></p> <p>2K.3 The EU HBML pilot study: measuring exposure in EU mothers and their children Cophes project</p> <p>2K.4 The WHO POPS in breast milk survey, <i>Maryse Arendt, Luxembourg</i></p>
16:00 - 17:00 Poster Area	Public health competencies		<p>2L. Health Education Chair: <i>Vesna Bejgovic, Serbia</i></p> <p>2L.1 What's in it for me? Lessons learnt on how to collect data on patient education programmes in diverse settings, <i>Maiken Rose Hjortbak, Denmark</i></p> <p>2L.2 Health education programme Safe World in City of Novi Sad, Serbia, 2009/2010, <i>Olja Aiciforovic Surkovic, Serbia</i></p> <p>2L.3 The evaluation of leadership skills among chief executive officers of Lithuanian public health institutions, <i>Mindaugas Stankunas, Lithuania</i></p> <p>2L.4 Improving the public health capacity to reduce health inequalities through graduate training in multidisciplinary intervention research, <i>Anne-Marie Hamelin, Canada</i></p> <p>2L.5 Career in public health for the medical students: for a better visibility of this speciality. A study in Batna (Algeria) and Rouen (France), <i>Marie-Pierre Tivolacci, Italy</i></p> <p>2L.6 Global Health in Medical Education in Italy: the results of a national survey of current opportunities in the period 2007-2010 in the perspective of Global Health as "essential" issue of medical learning, <i>Stefania Bruno, Italy</i></p> <p>2L.7 Community-Academic Partnership through A Community-Based Participatory Research Process as Knowledge Production and Action for a Healthy and Sustainable Neighborhood, <i>Karin Fröding, Sweden</i></p> <p>2L.8 Stimulating municipal government inter-sectoral collaboration: local support for the development of integrated health policy, <i>Mieke Steenbakkens, The Netherlands</i></p>

TIME/LOCATION	TRACK	ORGANISER	ACTIVITY
16:00 - 17:00 Poster Area	All inclusive public health		<p>2M. Women and health 2 Chair: <i>Carmen Aceijas, United Kingdom</i></p> <p>2M.1 Are Gender Egalitarian and Gender Traditional attitudes related to smoking in men and women in Britain? <i>Abita Bhaskar, United Kingdom</i></p> <p>2M.2 French women living in the Rhône-Alpes region and cervical cancer: awareness, screening practices and HPV vaccine acceptability according to educational level, <i>Julie Haesebaert, France</i></p> <p>2M.3 Gender inequalities in occupational health across Europe by welfare state regime <i>Javier Campos-Serna, Spain</i></p> <p>2M.4 Maternal educational level and growth of head circumference in early childhood; the Generation R study, <i>Selma Bouthoorn, The Netherlands</i></p> <p>2M.5 Social inequalities in pregnancy outcomes in the Murmansk County, Northwest Russia: a registry-based study on 22912 births, <i>Natalia Treskina, Russia</i></p> <p>2M.6 Lone mothers talking money and health. A discourse analysis of focus groups with Swedish lone mothers with financial difficulties, <i>Sara Fritzell, Sweden</i></p> <p>2M.7 Mother, single and divorced: a huge burden for a woman in Romania, <i>Corina-Aurelia Zugravu, Romania</i></p> <p>2M.8 Gender gap in disability pension across educational levels. The Hordaland Health study Cohort, 1997-99, Norway, <i>Inger Haukenes, Norway</i></p>
16:00 - 17:00 Poster Area	News in public health	EUPHA section on Public Health Epidemiology	<p>2N. Poster workshop: Towards an integration between human and animal health: the One Health experience Chair: <i>Giuseppe La Torre, Italy</i></p> <p>2N.1 Increasing the collaboration between human and animal medicine: the perspective of public health physicians, <i>Paolo Villari, Italy</i></p> <p>2N.2 One Health, the need for an holistic approach to human, veterinary and environmental medicine, <i>Bente Pedersen, Denmark</i></p>
16:00 - 17:00 Poster Area	Migrant and ethnic minority health	Open Society Institute	<p>20. Poster workshop: Empowering vulnerable groups to act on social determinants that impose inequalities in health Chairs: <i>Monika Kosinska, (EPHA), Belgium, Tamsin Rose, Belgium</i></p> <p>20.1 Building the capacity of Roma civil society organisations to advocate for their health and rights in health care, <i>Neda Milevska-Kostova, Macedonia</i></p> <p>20.2 EU health and social policies made for and with vulnerable groups? How can civil society speed up collaborative actions? <i>Dorota Sienkiewicz, EPHA</i></p> <p>20.3 Integration of Harm Reduction and General Practice in Outreach Settings lessons learned after 6 years, <i>Henrik Thiesen, FEANTSA</i></p>

TIME/LOCATION	TRACK	ORGANISER	ACTIVITY
16:00 - 17:00 Poster Area	Child and adolescent public health		<p>2P. Child and adolescent public health Chair: <i>Auke Wieggersma, The Netherlands</i></p> <p>2P.1 Physical development of 7 and 8 years old children of Lithuania (implementation of Childhood Obesity Surveillance Initiative in 2008 and 2010), <i>Ausra Petrauskiene, Lithuania</i></p> <p>2P.2 Links among physical development of 7 - 8 years old children and socio-demographic inequalities of families in Lithuania (2008 and 2010 survey), <i>Edita Albaviciute, Lithuania</i></p> <p>2P.3 Early triage among infants in preventive child health care and risk process monitoring in The Netherlands, <i>Maartje Niezen, The Netherlands</i></p> <p>2P.4 Work experience and style partially explain inter-physician differences in the identification of children with problems, <i>Sijmen Reijneveld, The Netherlands</i></p> <p>2P.5 Do we need health education in school as a separate subject or integrated content? <i>Gordana Pavlekovic, Croatia</i></p> <p>2P.6 A prospective study on dental attendance in a cohort of Flemish preschool children <i>Roos Leroy, Belgium</i></p> <p>2P.7 Birth weight and its association with teeth eruption in Russian infants, <i>Maria Gorbatova, Russia</i></p> <p>2P.8 Adolescents with diabetes have healthier eating patterns than a general population of adolescents from 18 countries, <i>Mogens Trab Damsgaard, Denmark</i></p> <p>2P.9 Racism and ethnic differences in blood pressure in a longitudinal study of British adolescents, 2003-2006, <i>Erik Lenguerrand, United Kingdom</i></p> <p>2P.10 Assessment of multilingual web survey for collecting health data from linguistically diverse adolescent population: a pilot study from Finland, <i>Susanna Raisamo, Finland</i></p>
16:00 - 17:00 Poster Area	Lifestyle		<p>2Q. Lifestyle 1 Chair: <i>Ulla Toft, Denmark</i></p> <p>2Q.1 Peer risk behavior, peer support and adolescent risk behavior, <i>Rúnar Vilhjálmsson, Iceland</i></p> <p>2Q.2 Journey through the music-listening habits with MP3 player in a group of adolescents: risk behaviors for health and consequent disorders, <i>Guglielmo Bonaccorsi, Italy</i></p> <p>2Q.3 IQ in childhood and later risk of alcohol-related disease and death, <i>Sara Sjölund, Sweden</i></p> <p>2Q.4 Family structure, parenting behavior and alcohol use in adolescence, <i>Rúnar Vilhjálmsson, Iceland</i></p> <p>2Q.5 The associations between personality factors, marijuana availability and marijuana experiences among young adolescents, <i>Beata Gajdosová, Slovakia</i></p> <p>2Q.6 Protective factors of substance use in youth subcultures, <i>Daniela Bobakova, Slovakia</i></p> <p>2Q.7 Sexual education in schools: the impact of participatory and reflective methodologies <i>Paula Nelas, Portugal</i></p> <p>2Q.8 Using statistics and practice to address inequalities in access to healthy diets in Sandwell England 2011, <i>Patrick Saunders, United Kingdom</i></p>

TIME/LOCATION	TRACK	ORGANISER	ACTIVITY
16:00 - 17:00 Poster Area	Health promotion 1		<p>2R. Behavioural change Chair: <i>Mette Aadahl, Denmark, Mark McCarthy, United Kingdom</i></p> <p>2R.1 Population-wide participation in health behaviour change programmes in Germany in 2009 <i>Susanne Jordan, Germany</i></p> <p>2R.2 The development in inequalities in smoking and binge drinking in the Capital Region of Denmark from 2007 to 2010, <i>Bodil Helbech Hansen, Denmark</i></p> <p>2R.3 A cluster randomized controlled trial of an adolescent smoking cessation intervention: Short and long term effects, <i>Peter Dalum, Denmark</i></p> <p>2R.4 Daily physical education at primary school. Potentials and barriers of a school-related prevention programme, <i>Sebastian Liersch, Germany</i></p> <p>2R.5 A physician's view of the social role of a drug representative influences the effect of drug promotion, <i>Sergey Gatsura, Russia</i></p> <p>2R.6 Risk health behaviour patterns - characteristics and regional differences in Germany <i>Elena von der Lippe, Germany</i></p> <p>2R.7 Oral health-promoting habits among dentate adults in Finland, <i>Battsetseg Tseveenjav, Finland</i></p> <p>2R.8 Adoption as a precondition for implementation - Results from a project disseminating workplace health promotion in Switzerland, <i>Susanne Hoffmann, Switzerland</i></p>
16:00 - 17:00 Poster Area	Health promotion 2		<p>2S. Food, physical activity and obesity Chair: <i>Chris Birt, United Kingdom</i></p> <p>2S.1 The impact of old-age retirement on leisure-time physical activity, <i>Jouni Lahti, Finland</i></p> <p>2S.2 Obesity and quality of life: Mediating effects of comorbidities, <i>Grazyna Broda, Poland</i></p> <p>2S.3 Dietetic care attributes to the public health of overweight patients in the Netherlands, 2006 - 2011, <i>Jacqueline Tol, The Netherlands</i></p> <p>2S.4 Dietitians in Germany: A survey on dietitians' professional profile and their work fields <i>Birgit Babitsch, Germany</i></p> <p>2S.5 Application of Sapere method in food education in Danish Kindergarten foodscapes <i>Sanne Sansolios, Denmark</i></p> <p>2S.6 Assessment and validation of fast food outlets using register in Denmark <i>Peter Erbs-Maibing, Denmark</i></p> <p>2S.7 Seaweed consumption and thyroid cancer risk in Japanese middle-aged women <i>Takehiro Michikawa, Japan</i></p>

TIME/LOCATION	TRACK	ORGANISER	ACTIVITY
16:00 - 17:00 Poster Area	Public mental health		<p>2T. Mental health Chair: <i>Lena Andersson, Sweden</i></p> <p>2T.1 The Mental Healthcare System Reform in Belgium: Assessing Network Outcomes and Inter-Organisational Effectiveness, <i>Pablo Nicaise, Belgium</i></p> <p>2T.2 Lower rates of psychiatric disorders in Italy compared with other European Countries <i>Mauro Giovanni Carta, Italy</i></p> <p>2T.3 The prevalence of psychological distress among Icelandic university women students compared to women in the general public, <i>Johanna Bernhardsdottir, Iceland</i></p> <p>2T.4 Why do young people experience high stress levels? <i>Pia Vedel Ankersen, Denmark</i></p> <p>2T.5 Covariates of perceived stress among residents in a deprived neighbourhood in Denmark <i>Carsten Bak, Denmark</i></p> <p>2T.6 Imprisonment among male psychiatric inpatients, <i>Steinn Steingrímsson, Iceland</i></p> <p>2T.7 Identification and management of maternal depression by paediatricians in Greece. A pilot study, <i>Christina Dimitrakaki, Greece</i></p> <p>2T.8 Pros and cons regarding the use of Selective Serotonin Reuptake Inhibitors in treating patients with depressive disorders, <i>Robert-Nicolae Popescu, Romania</i></p>
16:00 - 17:00 Poster Area	Interesting health posters		<p>2U. Sexual health Chair: <i>Anne Rygaard Hjortshøj, Denmark</i></p> <p>2U.1 Social and economic determinants in family planning in Romania, <i>Mihail Cristian Pirlog, Romania</i></p> <p>2U.2 Investigating inequalities in cervical cancer prevention: Will uptake of Human Papillomavirus (HPV) vaccination follow the same pattern as cervical screening? <i>Angela Pilkington, United Kingdom</i></p> <p>2U.3 Contraceptive practices in a Romanian population, <i>Monica Laura Cara, Romania</i></p> <p>2U.4 Prevalence of illicit drug use among female sex workers in Europe: an overview, <i>Marc Roelands, Belgium</i></p> <p>2U.5 The characteristics and beliefs of men buying sex in Finland, <i>Elena Regushevskaya, Finland</i></p> <p>2U.6 Investigating HIV-risk behaviors of female sex workers in Armenia: Inconsistent refusal of unprotected sex and its correlates, <i>Karine Markosyan, Armenia</i></p> <p>2U.7 Use of and trust in information sources on HIV: a cross-sectional population based survey in two Russian cities, <i>Aadne Aasland, Norway</i></p> <p>2U.8 Human immunodeficiency virus infection in the Arkhangelsk region of Russia 1992-2009 <i>Vera Utyugova, Russia</i></p> <p>2U.9 Attitudes towards HIV prevention in two Russian cities: a cross-sectional population based survey, <i>Tatiana Balaeva, Norway</i></p>
16:00 - 17:00 Room 16		EUPHA Section on Chronic Diseases	Annual meeting of the EUPHA Section on Chronic Diseases
16:00 - 17:00 Room 18		EUPHA Section on Health Promotion	Annual meeting of the EUPHA Section on Health Promotion

TIME/LOCATION	TRACK	ORGANISER	ACTIVITY
16:00 - 17:00 Room 19		EUPHA section on Injury Prevention and Safety Promotion	Annual meeting of the EUPHA Section on Injury Prevention and Safety Promotion
16:00 - 17:00 Room 20		EUPHA section on Migrant and Ethnic Minority Health	Annual meeting of the EUPHA section on Migrant and Ethnic Minority Health
16:00 - 17:00 Room 17		EUPHA section on Food and Nutrition	Annual meeting of the EUPHA section on Food and Nutrition
17:15 - 18:15 AUD 10-11-12			Plenary 2 Chair: <i>Finn Diderichsen, Denmark</i> Reducing inequality in health in Europe - progress in policies? <i>Sir Michael Marmot, United Kingdom</i> Inequality in health - WHO EURO policies and activities. Moving towards Health 2020 <i>Zsuzsanna Jakab, WHO Europe</i>
18:15 - 18:30 AUD 10-11-12			Extra plenary Chairs: <i>Antoine Flahault, ASPHER, Walter Ricciardi, EUPHA</i> Andrija Štampar Award

TIME/LOCATION	TRACK	ORGANISER	ACTIVITY
9:00 - 9:45 AUD. 10-11-12			<p>Plenary 3 Chair: <i>Arja R. Aro, Denmark</i> The contribution of preventive and curative health services to health, quality of life and welfare of the elderly population, <i>Jean-Marie Robine, France</i> The consequences of economic crises and the responses to them for population health <i>Martin McKee, United Kingdom</i></p>
Oral sessions			
10:15 - 11:45 AUD. 10-11-12	Welfare and public health	Katharina Rathmann, Hertie School of Governance Berlin and Berlin Graduate School of Social Sciences (Humboldt Universität zu Berlin)	<p>3A. Workshop: How Politics matters: Welfare State Regimes and Health Inequalities Chairs: <i>Matthias Richter, Germany</i> Work, Worklessness and the Political Economy of Health Inequalities, <i>Clare Bambra, United Kingdom</i> Social inequalities in health across Europe: Do welfare arrangements make a difference? <i>Espen Dahl, Norway</i> Welfare Regimes, Labour Markets and Population Health: A Global Hierarchical Cluster Analysis <i>Carles Muntaner, Canada</i> Social health inequalities between welfare state regimes: evidence, explanations and challenges <i>Terje Eikemo, Norway</i></p>
10:15 - 11:45 Room 16	European public health	European Commission	<p>3B. Evidence based prevention addressing welfare development in EU Member States (EU2) Chair: <i>Dirk Meusel, European Commission</i> The EU Health Programme – an introduction on behalf of EAHC, <i>Dirk Meusel, European Commission</i> EUNAAPA, IMPALA, PASEO and an overall strategy in addressing evidence based promotion of physical activity in EU Member States, <i>Alfred Ruetten</i> Correlation net: European Network Social Inclusion and Health <i>Eberhard Schatz</i> Developing competencies and professional standards for health promotion capacity building in Europe (CompHP), <i>Barbara Battel Kirk</i> PROMO - Best Practice In Promoting Mental Health In Socially Marginalized People In Europe <i>Aleksandra Matanov</i></p>
10:15 - 11:45 Room 17	Health services & systems		<p>3C. Physician practice Chairs: <i>Kirstine Magtengaard Robinson, Denmark, Bjørn Holstein, Denmark</i> Do health behaviours affect initiation of preventive medications? <i>Nana Folmann Hempler, Denmark</i> Is social distance perceived by the general practitioner between him/herself and his/her patient related to their agreement on patient's health status? <i>Anne-Cécile Schieber, France</i> A comparison between general practitioner group and single handed practice: a systematic review <i>Giulia Silvestrini, Italy</i> Complementary and alternative medicine: How does medical education affect students' opinions on its public health effects and their future practice in Turkey? <i>Nesrin Cilingiroglu, Turkey</i> Substitution of prescribing tasks from doctors to nurses: an international expert survey on forces, conditions and jurisdictional control, <i>Marieke Kroezen, The Netherlands</i> Integration and career interests of foreign general practitioners compared to other physicians working in secondary care or private sectors in Finland, <i>Hannamaria Kuusio, Finland</i></p>

TIME/LOCATION	TRACK	ORGANISER	ACTIVITY
10:15 - 11:45 Room 18	Consumers and patients	EUPHA section on Food and Nutrition	<p>3D. Workshop: Role of learning and memory in food choice and perception throughout the life span</p> <p>Chairs: <i>Ep Köster, The Netherlands, Hanna Lagström, Finland</i> Peri-natal food learning and memory, <i>Helene Hausner, Denmark</i> Description of maternal feeding practices and their impact on infants' acceptance of new foods <i>Christine Lange, France</i> Parental neophobia and children's exposure to novel foods, is there a connection? - The STEPS Study, <i>Jenni Vaarno, Finland</i> Habitual diet and changes in consumption of vegetables and milk products from pre-puberty till early adulthood: An 8-years follow-up study, <i>Arja Lyytikainen, Finland</i> The role of memory and food learning in the elderly, <i>Jos Mojet, The Netherlands</i></p>
10:15 - 11:45 Room 19	Public health policy	EUPHA	<p>3E. Round table: How to bring public health to all policies</p> <p>Chairs: <i>Walter Ricciardi, Italy and Dineke Zeegers Paget, EUPHA</i> Short reflection on the ministerial meeting in Poznan, <i>Stanislaw Tarkowski, Poland</i> How can HIA support Health in all Policies - policy brief, <i>Matthias Wismar, European Observatory</i> It's all about the data, <i>Marieke Verschuuren, The Netherlands</i> Assessing the health impact of policies, <i>Gabriel Gullis, Denmark</i> It's all about the money - using the burden of disease, <i>Beatriz Gonzalez Lopez-Valcarcel, Spain</i> Round Table discussion</p>
10:15 - 11:45 Room 20	Inequalities	WHO - Regional office for Europe	<p>3F. WHO session: Assessing the inequalities in environmental risks in Europe</p> <p>Chair: <i>Srdan Matic, WHO Europe</i> Opening: <i>Zsuzsanna Jakab, WHO Europe</i> Environmental health inequality reporting: the Parma commitments and the challenges faced <i>Matthias Braubach, WHO Europe</i> Environment-related inequalities (noise, green space access, passive smoke exposure), <i>Gabriele Bolte</i> Injury-related inequalities (falls, poisonings, traffic injuries, work injuries), <i>Ingrid Fast, Lucie Laflamme</i> Housing-related inequalities (damp, water supply, sanitation facilities, temperature problems, crowding), <i>Denis Zmirou, Severine Deguen</i> Podium discussion</p>
10:15 - 11:45 Room BV1	Sickness absence	EUPHA section on Social Security and Health	<p>3G. Workshop: Explaining sickness absence rates in men and women: questions emerging from gender theories provide insightful answers</p> <p>Chair: <i>Gunnel Hensing, Sweden</i> Gender differences in predictors of adult sickness absence - results from a 27 years follow-up of the Northern Swedish cohort, <i>Ellenor Mittendorfer Rutz, Sweden</i> Gender, work-home interface and emotional exhaustion among Serbian and Maltese human service professionals, <i>Katarina Putnik, The Netherlands</i> Is it masculine to turn up ill at work? A study on the association between traditional male role norms and sickness presenteeism amongst Danish balance workers, <i>Claus Hansen, Denmark</i> Can minority situation at work explain the differences in psychiatric sickness absence between women and men - an application of Rosabeth Moss Kanter's theory, <i>Gunnel Hensing, Sweden</i></p>

TIME/LOCATION	TRACK	ORGANISER	ACTIVITY
10:15 - 11:45 Room BV2	Chronic diseases		<p>3H. The burden of major chronic diseases Chairs: <i>Iveta Nagyova Rajnicova, Slovakia, Ola Ekholm, Denmark</i> Differences in cardiovascular disease mortality by geographical region and country of birth in six European countries, <i>Snorri Rafnsson, United Kingdom</i> Prevention of cardiovascular disease by means of statin therapy. Is the strategy equitable? <i>Helle Wallach Kildemoes, Denmark</i> Cardiovascular disease in primary care: multimorbidity and healthcare utilisation patterns <i>Beatriz Poblador, Spain</i> Population-based screening for colorectal cancer using an immunochemical faecal occult blood test. A comparison of invitation strategies, <i>Sofie Van Roosbroeck, Belgium</i> An evaluation of the impact of a dedicated welfare rights service for people with cancer and their carers in North East England between June 2008-January 2011, <i>Emma Noble, United Kingdom</i></p>
10:15 - 11:45 Room B3 M5	Public health research and innovation	EUPHA section on Public Mental Health	<p>3I. Workshop: Measuring mental health in population-based studies Chairs: <i>Jutta Lindert, Germany, Reiner Rugulies, Denmark, Lena Andersson, Sweden</i> Using register data to assess depression and functional disorders in the general population <i>Katja Longaard, Denmark</i> Lifecourse socioeconomic factors and mental health, <i>Maria Melchior, France</i> Using data from international studies in public mental health research, <i>Jutta Lindert, Germany</i></p>
10:15 - 11:45 Room B3 M6	Benefits and reliability of data collection	National Institute for Health and Welfare (THL), Finland and EAHC	<p>3K. Workshop: European Health Examination Survey - comparability by collaboration Chairs: <i>Hanna Tolonen, Finland, Simona Giampaoli, Italy</i> Introduction to the European Health Examination Survey, <i>Kari Kuulasmaa, Finland</i> Available sampling frames and participation rates, <i>Johan Heldal, Norway</i> Standardisation of the core measurements, <i>Johanna Maki-Opas, Finland</i> Establishing a new national HES in Slovakia, <i>Maria Avdilova, Slovakia</i> How to adapt European Health Examination Survey standards without loosing national trends <i>Antje Goesswald, Germany</i></p>
10:15 - 11:45 Room B3 M7	Public health competencies	EUPHA section on Health Promotion	<p>3L. Workshop: Health promotion and the social determinants of health: Bridging the gap between structure and agency Chairs: <i>Thomas Abel, Switzerland, Christiane Stock, Denmark</i> The agency-structure debate and the future of health promotion practice: targeting the individuals or the social determinants of health? <i>Eric Breton, France</i> Capitals, capabilities and health promotion: How social inequalities may become health inequalities, <i>Katherine Frohlich, Canada</i> Bridging structure and agency in health promotion: Adding the policy dimension as the 'missing link', <i>Alfred Rutten, Germany</i></p>

TIME/LOCATION	TRACK	ORGANISER	ACTIVITY
10:15 - 11:45 Room B3 M8	All inclusive public health		3M. Ecological health Chairs: <i>Ludwine Casteleyn, Belgium, Kathrine Strandberg-Larsen, Denmark</i> Testing for Granger causality between population health and economic output in selected OECD countries (1960-2008), <i>Blazej Lyszczyk, Poland</i> Social capital and mortality in Finland 2000-2009, <i>Tarja Nieminen, Finland</i> Size at birth and early life social characteristics predict educational outcomes in Swedish cohorts born 1915-1929 and 1973-1980, <i>Ilona Koupil, Sweden</i> Estimating the association between Disability Adjusted Life Years and population health determinants - a cross-national ecologic study, <i>Dietrich Plass, Germany</i> The epidemiologic relation between small ruminant farms and human Q fever, <i>Anja Brandsen-Schreijer, The Netherlands</i> Injury mortality among refugees and immigrants compared to native Danes, <i>Marie Norredam, Denmark</i>
10:15 - 11:45 Room B4 M1	News in public health		3N. Interesting miscellaneous orals Chair: <i>Fred Paccaud, Switzerland</i> Public disclosure of hospital outcomes data improves quality of care for patients admitted with hip fracture: the experience from two Italian Regions, <i>Luigi Pinnarelli, Italy</i> The effect of public-sector health care delivery on avoidable mortality: longitudinal cross-regional results from Italy, 1993-2003, <i>Cecilia Quercioli, Italy</i> Meta-analysis of the immunogenicity and tolerability of pandemic influenza A 2009 (H1N1) vaccines, <i>Lamberto Manzoli, Italy</i> Negative aspects of social relations and risk of development of IHD a longitudinal study of middle-aged Danish men and women, <i>Rikke Lund, Denmark</i> Does strong sense of coherence improve survival? A 14-year follow-up study among Finnish respondents, <i>Salla-Maarit Volanen, Finland</i>
11:45 - 12:30 Room 17		EUPHA section on Environment Related Disease	Annual meeting of the EUPHA section on Environment Related Disease
11:45 - 12:30 Room 20		EUPHA section on Public Mental Health	Annual meeting of the EUPHA Section on Public Mental Health
11:45 - 12:30 Room 19		EUPHA section on Public Health Economics	Annual meeting of the EUPHA Section on Public Health Economics
11:45 - 12:30 Room BV1		EUPHA section on Social Security and Health	Annual meeting of the EUPHA Section Social Security and Health
11:45 - 12:30 Room BV2		EUPHA section on Urban Public Health	Annual meeting of the EUPHA Section Urban Public Health

TIME/LOCATION	TRACK	ORGANISER	ACTIVITY
11:45-12:30 Room B3 M6		EUPHA Section on Infectious Diseases Control	Annual meeting of the EUPHA Section on Infectious Diseases Control
11:45 - 12:30 Room B3 M8		EUPHA Proposed Section on Health Impact Assessment	Annual meeting of the EUPHA proposed Section on Health Impact Assessment
11:45 - 12:30 Room 18		EUPHA Proposed Section on Public Health Monitoring and Reporting	Annual meeting of the proposed Section on Public Health Monitoring and Reporting
Moderated poster sessions			
12:30 - 13:30 Poster Area	Welfare and public health		<p>4A. Employment and health Chair: <i>Anne-Mette Momsen, Denmark</i></p> <p>4A.1 Work-related diseases among migrant workers in Italy and Spain: role of the type of contract <i>Nadia Mignolli, Italy</i></p> <p>4A.2 Differences in employment conditions between immigrant and autochthonous workers in Europe, <i>Elena Ronda, Spain</i></p> <p>4A.3 Working conditions and subsequent weight gain, <i>Eira Roos, Finland</i></p> <p>4A.4 Social differentials in non-employment following hospital admission for musculoskeletal disorders in Sweden during 2001-2006, <i>Johanna Falk, Sweden</i></p> <p>4A.5 The association between mental health status and unemployment among immigrant women in Sweden, <i>Anna-Clara Hollander, Sweden</i></p> <p>4A.6 Differences in major cardiovascular risk factors between unemployed and employed individuals in Poland - a cross-sectional study, <i>Pawel Zagodzdon, Poland</i></p> <p>4A.7 Breaking the 'vicious circle' of unemployment and health in Germany, <i>Alfons Hollederer, Germany</i></p>
12:30 - 13:30 Poster Area	European public health		<p>4B. Health in South Eastern Europe Chair: <i>Gena Grancharova, Bulgaria</i></p> <p>4B.1 Current trends in human resources for health of Ukraine, <i>Saveliy Rudzsky, Ukraine</i></p> <p>4B.2 Advance directives in palliative care units in Bulgaria, <i>Gena Grancharova, Bulgaria</i></p> <p>4B.3 Distribution of health payments and catastrophic health expenditures in the Republic of Macedonia, <i>Dance Gudeva Nikovska, Macedonia</i></p> <p>4B.4 Socio-economic transition and mortality from drowning in Lithuania: critical points in time and place, <i>Ramune Kalediene, Lithuania</i></p> <p>4B.5 Regional inequalities in the distribution of premature deaths in Romania, in 2009 <i>Carmen Elena Oprea, Romania</i></p> <p>4B.6 Value of life expectancy in Poland in period 1990-2009 in aspect of main health risks. The bottom-up approach, <i>Mariusz Geremek, Poland</i></p> <p>4B.7 Medicines consumption in Slovenia in 2010, <i>Marjetka Jelenc, Slovenia</i></p> <p>4B.8 Public health impact of the reference pricing system of medicines in Republic of Macedonia in 2009, <i>Verica Ivanovska, Macedonia</i></p>

TIME/LOCATION	TRACK	ORGANISER	ACTIVITY
12:30 - 13:30 Poster Area	Health services and systems		<p>4C. Professional practice Chair: <i>Allan Krasnik, Denmark</i></p> <p>4C.1 Attitude and knowledge of health services providers, <i>Daniela Mossang, Romania</i> 4C.2 The hybrid position of nurse practitioners in general practice, <i>Sophia Rosman, France</i> 4C.3 The role of Health Information Systems for the evaluation of appropriateness of therapy after Percutaneous Coronary Intervention in the Lazio region (Italy), <i>Ursula Kirchmayer, Italy</i> 4C.4 Periodic Health Examination - Call/Recall System, the target oriented promotion system established in 2005 by the Austrian Social Insurance, <i>Gerald Brunner, Austria</i> 4C.5 The Dutch experience to introduce Advanced Nurse Practitioners: an example for Germany? <i>Christoph Schweikardt, Germany</i> 4C.6 Factors influencing general practitioners in nutrition communication, <i>Gordana Pavlekovic, Croatia</i> 4C.7 Patient - physician communication and its influence on patients' perceptions of medical errors <i>Gena Grancharova, Bulgaria</i> 4C.8 Patient-doctor relationship in improving drug adherence, <i>Marcel Leppée, Croatia</i></p>
12:30 - 13:30 Poster Area	Consumers and patients		<p>4D. Patients' experiences and satisfaction Chair: <i>Jany Rademakers, The Netherlands</i></p> <p>4D.1 Which are (dis)continuity elements experienced by the Catalonian healthcare users? <i>Marta Beatriz Aller, Spain</i> 4D.2 How do patients of the Catalonian healthcare system perceive continuity of care? <i>María Luisa Vázquez, Spain</i> 4D.3 How do users of integrated healthcare networks in Catalonia perceive continuity of care? A qualitative multiple-case study, <i>Sina Waibel, Spain</i> 4D.4 Differences in perception between the immigrant and native population regarding continuity between care levels in Catalonia, <i>Josep Maria Colomé, Spain</i> 4D.5 Experience of the Consumer Emergency Care Satisfaction Scale on an Italian Emergency Room, <i>Gabriele Messina, Italy</i> 4D.6 Women's satisfaction with the waiting times of further investigation in breast screening <i>Ana Molina-Barceló, Spain</i> 4D.7 Satisfaction with primary health care services in urban community of Lithuania <i>Skirmante Starkuviene, Lithuania</i> 4D.8 An Evaluation of Patient Satisfaction With Family Practice in Republika Srpska (BIH) <i>Sanja Matovic Miljanovic, Serbia</i></p>

TIME/LOCATION	TRACK	ORGANISER	ACTIVITY
12:30 - 13:30 Poster Area	Public health policy		<p>4E. The economics of health Chair: <i>Helle Wallach Kildemoes, Denmark</i></p> <p>4E.1 Defending the economic value of public health interventions, <i>Astrid Brousselle, Canada</i> 4E.2 The supply and cost of public health in Alberta, Canada, <i>Jessica Moffatt, Canada</i> 4E.3 Patterns of utilisation of health care services in Catalonia, Spain, <i>Carmen Medina, Spain</i> 4E.4 Efficiency and efficacy of screening for Type II Diabetes mellitus, <i>Sophie Brunner-Ziegler, Austria</i> 4E.5 Costs for osteoporotic fractures in Italy: what is missing? <i>Antonella Sferrazza, Italy</i> 4E.6 Adverse event, incidence and cost reduction after a patient safety program, <i>José Luis Navarro Espigares, Spain</i> 4E.7 Rivoli Hospital (Turin-Italy) intensive care: comparison of closed versus open visiting <i>Riccardo Papalia, Italy</i> 4E.8 Health care utilisation and mortality in patients with COPD and diabetes, <i>Abad Diez, Portugal</i></p>
12:30 - 13:30 Poster Area	Inequalities		<p>4F. Lifestyle and pregnancy Chair: <i>Laust Mortensen, Denmark</i></p> <p>4F.1 Major health threats for pregnant women and their children in the 21st century, <i>Brigitte Piso, Austria</i> 4F.2 The lifestyle health behaviour of women in Poland over the time when conception is possible assessed during 2009-11, <i>Przemyslaw Bilinski, Poland</i> 4F.3 Physical exercise in pregnant women and its effect on the health of newborns in Poland (2009-11), <i>Przemyslaw Bilinski, Poland</i> 4F.4 Maternal smoking and the risk of atrial septal defect in infants, <i>Virginija Dulskiene, Lithuania</i> 4F.5 Reasons for quitting smoking among pregnant women in Northwest Russia: a qualitative study <i>Olga Kharkova, Russia</i> 4F.6 The effect of smoking during pregnancy on the health of newborns in Poland (2009-11) <i>Andrzej Wojtyła, Poland</i> 4F.7 Early pregnancy body mass index (BMI) and spontaneous preterm and very preterm birth: a Russian registry-based historical cohort study, <i>Ekaterina Sharashova, Russia</i> 4F.8 Dietary behaviour and blood morphology in post-partum women and newborns from Poland assessed during 2009-11, <i>Cezary Wojtyła, Poland</i></p>

TIME/LOCATION	TRACK	ORGANISER	ACTIVITY
12:30 - 13:30 Poster Area	Sickness absence		<p>4G. Sickness absence 2 Chair: <i>Annina Ropponen, Finland</i></p> <p>4G.1 Influence of working in nightshift on the health status of health workers in the Republic of Macedonia, <i>Dance Gudeva Nikovska, Macedonia</i></p> <p>4G.2 Absenteeism due to illness or accident in Greece. One more championship? <i>George Merekoulias, Greece</i></p> <p>4G.3 Measuring sick leave in the Danish municipal elder care sector: Is registered sickness benefit a valid proxy for actual sick leave of at least 15 days? <i>Christina Malmose Stapelfeldt, Denmark</i></p> <p>4G.4 Subgroup analyses on return to work in sick-listed Danish employees with low back pain in a randomised trial comparing brief and multidisciplinary intervention, <i>Chris Jensen, Denmark</i></p> <p>4G.5 Disability pension and everyday life: a period of transition and subjective aspects of future occupational life, <i>Annica Johansson, Norway</i></p> <p>4G.6 How do musculoskeletal pain, avoidant coping and sickness absence relate to each other? Findings from a prospective cohort study, <i>Ulla Christensen, Denmark</i></p> <p>4G.7 Self-perception of general health and pain as predictors of return to work two years after rehabilitation for traumatic injury, <i>Pierluigi Ballabeni, Switzerland</i></p> <p>4G.8 A qualitative study on return-to-work after breast cancer: Belgian stakeholders' diverse perspectives, <i>Corine Tiedtke, Belgium</i></p>
12:30 - 13:30 Poster Area	Chronic diseases		<p>4H. Cardiovascular disease Chair: <i>Allan Linneberg, Denmark</i></p> <p>4H.1 Time Trends in Population Proportions in Ideal Cardiovascular Health, <i>Anders Borglykke, Denmark</i></p> <p>4H.2 Alarming cardiovascular trends in eastern mediterranean countries, <i>Belgin Unal, Turkey</i></p> <p>4H.3 Does the association between union dissolution and ischemic heart disease depend on time since union dissolution? <i>Margit Kriegbaum, Denmark</i></p> <p>4H.4 Gaps in the prevention of cardiovascular disease among rural disadvantaged population in Bulgaria, <i>Nevyana Feschieva, Bulgaria</i></p> <p>4H.5 Secondary prevention of coronary heart disease at population level in Poland <i>Grazyna Broda, Poland</i></p> <p>4H.6 Completeness of percutaneous coronary intervention registration in the Danish Heart Register, 2008-09, <i>Tamima Rasul, Denmark</i></p> <p>4H.7 Reduction in out-of-hospital cardiovascular mortality in first 10-days of January after introduction of 10-days winter holidays in 2005: an analysis of 24730 death certificates in Arkhangelsk, Russia, <i>Elena Neporada, Russia</i></p> <p>4H.8 Socioeconomic and environmental factors are the main determinants of regional differences in cardiovascular mortality in Poland – an ecological analysis, <i>Grazyna Broda, Poland</i></p>

TIME/LOCATION	TRACK	ORGANISER	ACTIVITY
12:30 - 13:30 Poster Area	Public health research and innovation		<p>4I. Health services 2 Chair: <i>Jouke van der Zee, The Netherlands</i></p> <p>4I.1 Composite indicators to evaluate the performance of national health systems in Europe: what matters? <i>Anton Giulio De Belvis, Italy</i></p> <p>4I.2 Assessing the relationship between health care market competition and health care quality under Taiwan's national health insurance programme, <i>Kuo-Cherh Huang, Taiwan</i></p> <p>4I.3 Pay for Performance in primary care: towards quality in healthcare, <i>Silvio Capizzi, Italy</i></p> <p>4I.4 Consumer choice of healthcare providers: the role of status-quo bias in the Dutch healthcare system, <i>Diana Delnoij, The Netherlands</i></p> <p>4I.5 Channelling consumers towards preferred providers, <i>Romy Bes, The Netherlands</i></p> <p>4I.6 Diabetes screening in primary care for preventive interventions, <i>Chiara Lorini, Italy</i></p> <p>4I.7 Patient safety and quality of care, <i>Maurizio Dore, Italy</i></p> <p>4I.8 Consumer judgement and risk perception on availability of over-the-counter-drugs <i>Anne Brabers, The Netherlands</i></p> <p>4I.9 Inequality in 30-day mortality and wait for surgery after hip fracture: the impact of the Regional Health Care Evaluation Programme in Lazio (Italy), <i>Paola Colais, Italy</i></p> <p>4I.10 Relationship between volumes and outcomes in colon cancer surgery, <i>Jacopo Lenzi, Italy</i></p>
12:30 - 13:30 Poster Area	Benefits and reliability of data collection	National Board of Health, Denmark, Danish Regions, Capital Region of Denmark, Central Denmark Region, The North Denmark Region, Region Zealand, Region of Southern Denmark, the National Institute of Public Health	<p>4K. Poster workshop: A National Health Survey in Denmark - an important tool in the prioritizing, planning and monitoring of local health initiatives Chairs: <i>Line Raahauge Hvass, Denmark, Charlotte Glümer, Denmark</i></p> <p>4K.1 Methods of the National Health Survey, <i>Finn Breinholt, Denmark</i></p> <p>4K.2 The collaboration between the regions and the municipalities - an example! <i>Jane Pedersen, Denmark</i></p> <p>4K.3 The National Health Survey 2010 Online Database, <i>Ola Ekholm, Denmark</i></p>

TIME/LOCATION	TRACK	ORGANISER	ACTIVITY
12:30 - 13:30 Poster Area	Public health competencies		<p>4L. Trans European public health Chair: <i>Antoine Flahault, France</i></p> <p>4L.1 Mechanisms of issuing Public Health Policies - A process which can be transferred to the new European Union Members, <i>Mihaela Haratau, Romania</i></p> <p>4L.2 Is gender policy related to the gender gap in cause-specific mortality? A study of 22 OECD countries 1973-2008, <i>Mona Backhans, Sweden</i></p> <p>4L.3 The implications of European integration for health systems in two transitioning states <i>R. Gregory Reilly, United Kingdom</i></p> <p>4L.4 The current state of national cancer plan policies in the EU countries, <i>Tit Albreht, Slovenia</i></p> <p>4L.5 Country level housing conditions: a cross sectional study in Europe, <i>Mathilde Sengoelge, Sweden</i></p> <p>4L.6 Validation of the European Health Literacy Survey (HLS-EU). Locations: Ireland, The Netherlands, Greece. Dates: June 2010 - October 2010, <i>James Fullam, Ireland</i></p> <p>4L.7 Global consensus for social accountability of medical schools. A challenge for international public health, <i>Joel Ladner, France</i></p> <p>4L.8 Review of public health capacities in the European Union, <i>Christoph Aluttis, The Netherlands</i></p> <p>4L.9 Creating networks to support public health research capacity, the Quebec experience <i>Gilles Paradis, Canada</i></p> <p>4L.10 The activities of the World Federation of Public Health Associations, <i>Marta Lomazzi, WFPHA</i></p>
12:30 - 13:30 Poster Area	All inclusive public health		<p>4M. Interesting miscellaneous posters Chair: <i>Markus Kaufmann, Switzerland</i></p> <p>4M.1 KINSHIP PROJECT. An European qualitative research on the needs of kinship carers of children and adolescent descendants of drug users, <i>Francisco Guillen Grima, Spain</i></p> <p>4M.2 POSEIDON "Promoting Optimisation, Safety, Experience sharing & quality Implementation for Donation Organisation & Networking in Unrelated Hematopoietic stem cell (HSC) transplantation in Europe": main results and policy recommendations, <i>Anne Cambon-Thomson, France</i></p> <p>4M.3 Cost of illness analysis of Haemophilia A: resource use and direct costs in Italy <i>Maria Assunta Veneziano, Italy</i></p> <p>4M.4 Estimating a preference-based index for health states of dependency, <i>Eva Rodriguez-Miguez, Spain</i></p> <p>4M.5 The use of knowledge translation in developing evidence for public health policy and practice: a staged, multi-methods study in England, 2007-2009, <i>Mima Cattan, United Kingdom</i></p> <p>4M.6 Labour Market Status and Minor Psychiatric Morbidity through the Lifecourse: Longitudinal Analysis of the British Household Panel Survey, 1992-2008, <i>Ellen Flint, United Kingdom</i></p> <p>4M.7 Sociomedical parent-child screenings: a survey and comparison among 9 European countries <i>Roman Winkler, Austria</i></p> <p>4M.8 Risk assessment of work-related neurological and musculoskeletal disorders in non-ferrous ore mining, <i>Zlatka Stoyneva, Bulgaria</i></p> <p>4M.9 Efficacy of Roma health mediator programmes in Bulgaria, Macedonia, Romania, Serbia, Slovakia, and Ukraine: a review from March to June 2011, <i>Marta Schaaf, United States</i></p> <p>4M.10 On the need for mixed methods research in public health sciences, <i>Charli Eriksson, Sweden</i></p> <p>4M.11 Use of microbicide gels in preventing Human Immunodeficiency Virus infection in heterosexual relationships: A meta-analysis of global trials 2005-2010, <i>Tendai Rushwaya, United Kingdom</i></p>

TIME/LOCATION	TRACK	ORGANISER	ACTIVITY
12:30 - 13:30 Poster Area	News in public health	EUPHA section on Health Promotion	<p>4N. Poster workshop: Drug prevention in educational settings: The role of social networks and social norms</p> <p>Chairs: <i>Christiane Stock, Denmark, Morten Hulvej Rod, Denmark</i></p> <p>4N.1 Perceived accessibility of substances, normative estimates of substance use and substance use among young adolescents in Slovakia, <i>Olga Orosova, Slovakia</i></p> <p>4N.2 The Social Norms Intervention for the prevention of Polydrug use (SNIFE) project <i>Guido Van Hal, Belgium</i></p> <p>4N.3 The significance of social relations in tobacco, alcohol and drug prevention: An intervention project in Danish vocational schools, <i>Liselotte Inghold, Denmark</i></p>
12:30 - 13:30 Poster Area	Migrant and ethnic minority health		<p>40. Migrant and minority health</p> <p>Chair: <i>Signe Smith Nielsen, Denmark</i></p> <p>40.1 A life course framework for epidemiological studies of health risks and outcomes in migrants <i>Jacob Spallek, Germany</i></p> <p>40.2 Attitudes towards (e)migration in socioeconomic and psychosocial context among Slovak university students, <i>Ondrej Kalina, Slovakia</i></p> <p>40.3 Can social dominance orientation predict racial discrimination in medical consultations? <i>Brice Lepière, Belgium</i></p> <p>40.4 Policies and practices in the health related reception of quota refugees in Denmark <i>Hanne Winther Frederiksen, Denmark</i></p> <p>40.5 Entitlements of undocumented migrants to healthcare, a comparative study in 16 European countries, 2009-10, <i>Juliette Poirson, France</i></p> <p>40.6 Entitlement, access to healthcare and health status of undocumented migrants; a multi-disciplinary and multilevel study in Cyprus, Malta, Poland and Romania, 2010, <i>Anne Soler, France</i></p> <p>40.7 Socioeconomic Status of Elderly People in Transitional Kosovo, <i>Naim Jerliu, Kosovo</i></p> <p>40.8 Improving the TB control in homeless people in Romania - model of partnership among public institutions and civil society, <i>Florentina Furtunescu, Romania</i></p>
12:30 - 13:30 Poster Area	Child and adolescent public health		<p>4P. Obesity in children and adolescents</p> <p>Chair: <i>Enni Mertanen, Finland</i></p> <p>4P.1 Systematic Review and meta-analysis of the prevalence of overweight and obesity among school-age children in Italy, <i>Rosella Saulle, Italy</i></p> <p>4P.2 Overweight children tend to underreport their weight, <i>Andrea Madarasova Geckova, Slovakia</i></p> <p>4P.3 Prevalence and trends of Metabolic Syndrome and its components in Siberian adolescent population, <i>Larisa Zavyalova, Russia</i></p> <p>4P.4 Eating habits of Lithuanian school-aged children: changes in context of social and economic factors from 2002 to 2010, <i>Reda Lagunaite, Lithuania</i></p> <p>4P.5 Interdisciplinary care of children and adolescents in an obesity outpatient clinic <i>Ina Poeche-Guckelberger, Germany</i></p>

TIME/LOCATION	TRACK	ORGANISER	ACTIVITY
12:30 - 13:30 Poster Area	Lifestyle		<p>4Q. Lifestyle in children and adolescents Chairs: <i>Annette Andersen, Denmark, Horst Noack, Austria</i> 4Q.1 Connection between children participation in extracurricular recreational activities and success in school, <i>Ana Puljak, Croatia</i> 4Q.2 Safe with the sun, <i>Simona Ursic, Slovenia</i> 4Q.3 Leisure time activities as a risk of injuries among adolescents in Latvia, <i>Anita Villerusa, Latvia</i> 4Q.4 Child's diet and mother's interest in healthy eating in the prospective dietary intervention trial in childhood and adolescence in Finland, <i>Sanna Talvia, Finland</i> 4Q.5 Sun exposure behaviors in children and parental attitudes: a pilot study in Romania and Slovakia, <i>Ioana-Andreea Rus, Romania</i> 4Q.6 Physical exercise in Polish youth and young adults (2010-11), <i>Przemyslaw Bilinski, Poland</i> 4Q.7 Different forms of sedentary behaviours and aggressive behaviour among school-aged children <i>Ferdinand Salonna, Slovakia</i> 4Q.8 Exploring students' health: "another brick in the wall", <i>Cecilia Quercioli, Italy</i> 4Q.9 Theatre as health-edutainment for children, <i>Dan Grabowski, Denmark</i> 4Q.10 Lifestyle health behaviour and perceptions of body satisfaction, image and ideal body weight (BMI) in Polish youth (2010-11), <i>Przemyslaw Bilinski, Poland</i></p>
12:30 - 13:30 Poster Area	Health promotion 1		<p>4R. Alcohol Chair: <i>Katrine Strandberg-Larsen, Denmark</i> 4R.1 International differences in health inequalities and alcohol use, <i>Kim Bloomfield, Germany</i> 4R.2 Prevalence and sociodemographic predictors of transitions across six stages of alcohol use in Romania, <i>Silvia Gabriela Scintee, Romania</i> 4R.3 Alcohol consumption and peer effect : a social network analysis of college students <i>Vincent Lorant, Belgium</i> 4R.4 Community health determinants of alcohol drinking among college students, <i>Vincent Lorant, Belgium</i> 4R.5 Social differences and trends in regular alcohol consumption in Lithuania from 1994 to 2010 <i>Jurate Klumbiene, Lithuania</i> 4R.6 Nonbeverage alcohol consumption in Estonia, <i>Kersti Pärna, Estonia</i> 4R.7 Risk-consumption of alcohol among elderly in Sweden 2008, <i>Carina Persson, Sweden</i></p>

TIME/LOCATION	TRACK	ORGANISER	ACTIVITY
12:30 - 13:30 Poster Area	Health promotion 2		<p>4S. Towards a smoke-free world Chair: <i>Charlotta Pisinger, Denmark</i></p> <p>4S.1 Modern approaches to control smoking among the population of Sofia, Bulgaria <i>Jasmine Pavlova, Bulgaria</i></p> <p>4S.2 What interventions are most effective in combination with mass media campaigns in reducing tobacco use initiation? A systematic review of cluster RCTs, <i>Ferruccio Pelone, Italy</i></p> <p>4S.3 How being a parent influences smoking behaviour in Europe ? An East/West contrast- <i>Viviane Kovess-Masféty, France</i></p> <p>4S.4 Global Health Professions Student Survey: Smoking Policies of Medical Schools and Second-hand Smoke Exposure among Medical Students in Turkey, <i>Tacettin Inandi, Turkey</i></p> <p>4S.5 Tobacco use and cessation counselling among health professional students, 2010 <i>Carlos Beat Quinto, Switzerland</i></p> <p>4S.6 Smoke-free universities in Yerevan, Armenia, 2009, <i>Arusyak Harutyunyan, Armenia</i></p> <p>4S.7 Development in the smoking behavior of Danes compared to changes in smoking policy <i>Betina Verwohlt, Denmark</i></p> <p>4S.8 Can a 24 hour smoking cessation programme improve the intention to quit of daily smokers? Evaluation of a 2009 pilot study in Flanders, Belgium, <i>Bart Vriesacker, Belgium</i></p> <p>4S.9 Are tweens safe at home from second-hand tobacco smoke exposure? Evidence from Eastern Europe, <i>Alexandra Brinzaniuc, Romania</i></p>
12:30 - 13:30 Poster Area	Public mental health		<p>4T. Mental health and wellbeing Chair: <i>Jutta Lindert, Germany</i></p> <p>4T.1 Work-life balance and health: The influence of the welfare state, <i>Thorsten Lunau, Germany</i></p> <p>4T.2 Salutogenic health indicators and work experience factors - a comparison between nurses and teachers in Lithuania, <i>Ingemar Andersson, Sweden</i></p> <p>4T.3 Sense of coherence as a predictor of health-related quality of life among coronary heart disease patients, <i>Barbora Silarova, Slovakia</i></p> <p>4T.4 Process and outcome mental health indicators using administrative databases in Italy <i>Stefano Mimmi, Italy</i></p> <p>4T.5 Differences in health status and well-being of the elderly in three Croatian districts <i>Drazenka Vadla, Croatia</i></p> <p>4T.6 School children's mental health in Europe: do German elementary school children report differences in mental health in northern Germany's former eastern vs. western part? <i>Dietmar Goelitz, Germany</i></p> <p>4T.7 Individual and social identity of residents living in old people's homes in Slovenia <i>Lijana Zaletel-Kragelj, Slovenia</i></p>

TIME/LOCATION	TRACK	ORGANISER	ACTIVITY
12:30 - 13:30 Poster Area	Interesting health posters		4U. Environment and public health Chair: <i>Stan Tarkowski, Poland</i> 4U.1 Environmental pollution and health risk: the perception of an Italian sample <i>Anna Caruana, Italy</i> 4U.2 EO2HEAVEN - Earth Observation and Environmental Modelling for the Mitigation of Health Risks, <i>Jana Arloth, Germany</i> 4U.3 Living conditions and health care use in periurban settlement with mostly Roma population <i>Erzebet Ac Nikolic, Serbia</i> 4U.4 Environmental and financial sustainability in healthcare organisations: the experience of the Italian National Health Service, <i>Agnese Lazzari, Italy</i> 4U.5 Air temperature and daily counts of bulance calls in Arkhangelsk, Russia, 2000-2009 <i>Andrej Grijbovski, Norway</i> 4U.6 The projected impact of climate change on the daily mortality: a case study in Archangelsk city in Northwest Russia, <i>Zhanna Varakina, Russia</i> 4U.7 Estimates of the health risk reduction associates with attainment of the new particulate matter standards in Poland, a top-down risk assessment, <i>Joanna Kobza, Poland</i> 4U.8 Cumulative risk assessment of chloroform in tap water in Novodvinsk, Northwest Russia <i>Tatiana Unguryanu, Russia</i>
12:30 - 13:30 Room B3 M5		EUPHA section on Child and Adolescent Public Health	Annual meeting of the EUPHA Section on Child and Adolescent Public Health
12:30 - 13:30 Room B3 M6		EUPHA section Ethics in Public Health	Annual meeting of the EUPHA section Ethics in Public Health
12:30 - 13:30 Room B3 M7		EUPHA section on Health Services Research	Annual meeting of the EUPHA Section Health Services Research
Oral sessions			
13:45-15:15 AUD 10-11-12	Welfare and public health		5A. Social inequalities in sickness absence Chair: <i>Claus Vinther Nielsen, Denmark, Ulrik Steen, Denmark</i> Gender differences in predictors of adult sickness absence - results from a 27 years follow-up of the Northern Swedish cohort, <i>Ellenor Mittendorfer Rutz, Sweden</i> Social inequalities in sickness: Does welfare state regime type make a difference? <i>Kjetil A. van der Wel, Norway</i> Unemployment and disability pension. An 18 year follow-up study from a Norwegian County <i>Morten Stöver, Norway</i> Socioeconomic differences in disability retirement in Finland: contribution of health, health behaviors and working conditions, <i>Anu Polvinen, Finland</i> Medical welfare dependence within families: a cohort study of health, socioeconomic status and work disability in young people and their parents. The HUNT Study, Norway, <i>Kristine Pape, Norway</i> Job-mobility and health, <i>Else Nygaard, Denmark</i>

TIME/LOCATION	TRACK	ORGANISER	ACTIVITY
13:45-15:15 Room 16	European public health	European Commission	<p>5B. Implementation of EU legislation as a way of contributing to EU wide welfare development (EU3)</p> <p>Chairs: <i>Ioana Raluca Siska, European Commission, Dirk Meusel, European Commission</i></p> <p>The EU Health Programme – an introduction on behalf of EAHC, <i>Dirk Meusel, European Commission</i></p> <p>EU-BLOOD-INSPECTION (EuBIS) and EU-Q-BLOOD-SOP as examples for the implementation of the EC Directive on quality and safety for the collection, testing, processing, storage and distribution of human blood and blood components, <i>Christian Seidl</i></p> <p>EUSTITE and SOHOS&V aiming at the implementation of the Directive of human tissues and cells <i>Eliana Porta</i></p> <p>ETPOD, EULID, ELIPSY, and ODEQUS as examples for the implementation of the Action Plan and the preparation of the EC Directive on standards of quality and safety of human organs intended for transplantation, <i>Marti Manyalich</i></p>
13:45-15:15 Room 17	Health services and systems	EUPHA section on Public Mental Health	<p>5C. Workshop: Mental Healthcare Systems Reforms in Europe</p> <p>Chairs: <i>Vincent Lorant, Belgium, Jutta Lindert, Germany</i></p> <p>The Mental Healthcare System Reform in Belgium: Assessing Network Outcomes and Inter-Organisational Effectiveness, <i>Pablo Nicaise, Belgium</i></p> <p>Providing care to immigrants in long-term mental health services across Europe: considerations for practical reform, <i>Sima Sandhu, United Kingdom</i></p>
13:45-15:15 Room 18	Consumers and patients		<p>5D. Parenting and/or education</p> <p>Chairs: <i>Mads Kamper-Jørgensen, Denmark, Eva Ladekjær Larsen, Denmark</i></p> <p>Integrated educational systems: Educational success - poor health? <i>Katharina Rathmann, Germany</i></p> <p>A Systematic Review of the Effect of the School Environment on Adolescent Emotional Health <i>Judi Kidger, United Kingdom</i></p> <p>School performance, health and SES in Finland - findings from a high-performing PISA country <i>Sakari Karvonen, Finland</i></p> <p>School experiences and medicine use for pain: cross sectional study of adolescents in 18 European countries, <i>Björn Holstein, Denmark</i></p> <p>The effects of a parental program on alcohol use among Swedish adolescents, <i>Camilla Pettersson, Sweden</i></p> <p>Effectiveness of the Primary care Triple P in preventive child healthcare: a randomised controlled trial, <i>Edwin Spijkers, The Netherlands</i></p>
13:45-15:15 Room 19	Public health policy	EuSANH secretariat	<p>5E. Workshop: Translating science into policy - illustration of a methodological framework for science advice</p> <p>Chairs: <i>Louise Gunning-Schepers, The Netherlands, Dorine Coenen, The Netherlands</i></p> <p>Role of science advice at a European level, <i>Louise Gunning-Schepers, The Netherlands</i></p> <p>A common methodological framework of Science Advice - Steps, principles and guidelines <i>Eert Schoten, The Netherlands</i></p> <p>A common methodological framework of Science Advice - The use of science advice in Europe <i>Paloma Palma, Spain</i></p> <p>Case study - Determinants of a successful implementation of population based cancer screening programs, <i>Susanne Allander, Sweden</i></p> <p>Case study - The Childhood Leukaemia Project: evaluation of a bottom-up international collaboration between scientific health advisory bodies within the EuSANH framework, <i>Katty Cauwerts, Belgium</i></p>

TIME/LOCATION	TRACK	ORGANISER	ACTIVITY
13:45-15:15 Room 20	Inequalities	Lorraine Stewart, Health Protection Agency	<p>5F. Workshop: Undertaking regional/local public health assessments in Europe using environmental health indicators</p> <p>Chairs: <i>Lorraine Stewart, United Kingdom, Odile Mekel, Germany</i></p> <p>Overview of Use of sub-national indicators to improve public health in Europe (UNIPHE) <i>Lorraine Stewart, United Kingdom</i></p> <p>Development of indicators for sub-national population health assessments <i>Ingrida ZurlYTE, Lithuania, Adedoyin Awofisayo, United Kingdom</i></p> <p>Development of harmonised sub-national environmental health information system <i>Anna Paldy, Hungary</i></p> <p>Compendium of policies and interventions that deliver positive health outcomes, <i>Odile Mekel, Germany</i></p> <p>Discussion</p>
13:45-15:15 Room BV1	Sickness absence		<p>5G. Sickness absence and work capacity</p> <p>Chairs: <i>Reiner Rugulies, Denmark, Karsten Thielen, Denmark</i></p> <p>Explaining educational differences in work ability - the role of working conditions and health related factors, <i>Risto Kaikkonen, Finland</i></p> <p>School dropout and social insurance benefits in young adulthood - a major public health challenge: A 10-year prospective study, The Young-HUNT 1 study (Norway), <i>Karin De Ridder, Norway</i></p> <p>Can Work ability explain the distributional differences of sickness absence over socioeconomic groups? <i>Jesper Löve, Sweden</i></p> <p>Health-related work functioning instruments in workers with common mental disorders: a systematic review of measurement properties, <i>Femke Abma, The Netherlands</i></p> <p>Evaluation of the effectiveness of occupational injury prevention programmes at the company level <i>María López Ruiz, Spain</i></p> <p>Return to work (RTW) in comprehensive occupational rehabilitation - predictive properties of Readiness for RTW scale, <i>Tore Norendal Braathen, Norway</i></p>
13:45-15:15 Room BV2	Chronic diseases	Nofer Institute of Occupational Medicine	<p>5H. Workshop: Environmental cancer as a public health problem - integration of the research and education activities in Europe</p> <p>Chair: <i>Konrad Ryzdzynski, Poland</i></p> <p>Validation of biomarkers for the study of environmental carcinogens, <i>Peter Farmer, United Kingdom</i></p> <p>Integrating biomarkers into molecular epidemiological studies on cancer, <i>Paolo Vineis, United Kingdom</i></p> <p>Environmental Cancer Risks, Nutrition and Individual Susceptibility (ECNIS) Network of Excellence Centre for Research and Education on Cancer, Environment and Food (ECRECEF) <i>Konrad Ryzdzynski, Poland</i></p>

TIME/LOCATION	TRACK	ORGANISER	ACTIVITY
13:45-15:15 Room B3 M5	Public health research and innovation	Division of Insurance Medicine, Karolinska Institutet, Stockholm, Sweden and Department of Social Research, University of Helsinki, Helsinki, Finland	<p>5I. Workshop: Twins: a powerful study design to control for genetic and environmental influences in public health research</p> <p>Chair: <i>Ute Bultmann, The Netherlands</i></p> <p>Methodological aspects of twin studies to disentangle genetic and environmental effects <i>Karri Silventoinen, Finland</i></p> <p>Co-twin control studies for investigation of risk factors for disability pensions, <i>Annina Ropponen, Finland</i></p> <p>Sex, age and cohort differences in the relative importance of genetic and environmental factors for self-rated health, <i>Pia Svedberg, Sweden</i></p> <p>Genetic liability to disability pension: prospective twin studies in Finland and Sweden <i>Jurgita Narusyte, Sweden</i></p>
13:45-15:15 Room B3 M6	Benefits and reliability of data collection	ECHIM project partners	<p>5K. Workshop: Improved data availability for the European Community Health Indicators; European Health Interview Survey, data collection pilot, and new DG SANCO dissemination tools</p> <p>Chairs: <i>Arpo Aromaa, Finland, Marieke Verschuuren, The Netherlands</i></p> <p>First results of the European Health Interview Survey (EHIS) and the outcomes of the European Community Health Indicators Monitoring project (ECHIM) data collection pilot, <i>Jörgen Thelen, Germany</i></p> <p>Plans for the future of the European Health Interview Survey (EHIS) and the revision of the questionnaire, <i>Bart De Norre, Eurostat</i></p> <p>Dissemination of European Community Health Indicators through the HEIDI data tool and wiki, <i>Karl Freese, European Commission</i></p>
13:45-15:15 Room B3 M7	Public health competencies	Open Society Foundations, Public Health Program	<p>5L. Round table: Monitoring in Health - Civil society's contribution to assessing and improving policies and practices</p> <p>Chair: <i>Erin Howe, United States</i></p> <p>What is community monitoring and how can it contribute to improving public health services? <i>Abhijit Das, India</i></p> <p>Community mobilisation to address health inequities in primary health care in Veliko Turnovo, Bulgaria, <i>Deyan Kolev, Bulgaria</i></p> <p>Community assessments of maternal and child health services in Neamt County, Romania <i>George Radulescu, Romania</i></p> <p>Why is community-generated evidence useful to improve public health policies and programmes and address health inequities? <i>Martin McKee, United Kingdom</i></p>

TIME/LOCATION	TRACK	ORGANISER	ACTIVITY
13:45-15:15 Room B3 M8	All inclusive public health		<p>5M. Overweight and nutrition</p> <p>Chairs: <i>Chris Birt, United Kingdom, Cathrine Lau, Denmark</i></p> <p>Significant changes in overweight rates in Russian adolescent population during the last two decades (1989-2009), <i>Diana Denisova, Russia</i></p> <p>Socioeconomic indicators as determinants of major weight gain: a follow-up study, <i>Tina Seiluri, Finland</i></p> <p>Sleep duration and overweight in European children - Is the association modified by geographic region? <i>Sabrina Hense, Germany</i></p> <p>Acquired tastes: Children's nutritional trajectories from birth to early childhood <i>Valeria Skafida, United Kingdom</i></p> <p>The association between availability of fast-food outlets and intake of fast-food <i>Charlotte Glümer, Denmark</i></p> <p>Negotiating health: the role of the World Health Organization in addressing the marketing of food to children, <i>Rachel Irwin, United Kingdom</i></p>
13:45-15:15 Room B4 M1	News in public health	EUPHA section on Public Health Practice and Policy	<p>5N. Workshop: Conflict, migration and public health</p> <p>Chair: <i>Natasha Muscat, Malta</i></p> <p>Three presentations on the subject from WHO/EURO, Italy and Malta</p> <p>Followed by an interactive discussion</p>
Oral sessions			
15:45-17:15 Aud. 10-11-12	Welfare and public health	EuroHealthNet	<p>6A. Round table: Tackling the gradient in health amongst children and their families: analysis of evidence and policies</p> <p>Chair: <i>Caroline Costongs, EuroHealthNet</i></p> <p>The Gradient Evaluation Framework (GEF), <i>John Davies, United Kingdom</i></p> <p>Applying Public Health Policies to Effectively Reduce Health Inequalities amongst Families and Children, <i>Annemiek Dorgelo, The Netherlands</i></p> <p>Social Capital and Social Inequality in Adolescents? Health in 601 Flemish Communities: a Multilevel Analysis, <i>Bart De Clercq, Belgium</i></p> <p>Policies to level the social gradient in health among families with children in four European welfare states, <i>Elisabeth Fosse, Norway</i></p>
15:45-17:15 Room 16	European public health	Open Society Foundations Public Health Program, Roma Health Project	<p>6B. Round table: Making better use of EU Structural Funds to reduce health inequalities: the perspective of marginalised groups</p> <p>Chair: <i>Tamsin Rose, Belgium</i></p> <p>Panel discussants: <i>Deyan Kolev, Bulgaria, Judith Klein, Mental Health Initiative, Charles Price, European Commission, Andor Urmos, European Commission, Carsten Rasmussen, European Commission</i></p>
15:45-17:15 Room 17	Health services and systems	Department of Public Health, ErasmusMC, Rotterdam	<p>6C. Workshop: enable mortality: indicator of health care performance?</p> <p>Chair: <i>Johan Mackenbach, The Netherlands</i></p> <p>Effectiveness of health care interventions; a literature review, <i>Martin McKee, United Kingdom</i></p> <p>Between-country variations in the timing of introduction of new interventions, <i>Ragnar Westerling, Sweden</i></p> <p>Association of mortality trends with health care interventions, <i>Rasmus Hoffmann, The Netherlands</i></p> <p>Selection of enable mortality indicators: a Delphi study, <i>Martin McKee, United Kingdom</i></p>

TIME/LOCATION	TRACK	ORGANISER	ACTIVITY
15:45 - 17:15 Room 18	Consumers and patients	Tilburg University in cooperation with NIVEL	<p>6D. Workshop: Direct-to-consumer advertising of prescription medicines Chair: <i>Diana Delnoij, The Netherlands</i> Empowering patients to access information on prescription medicines: the reform proposed by the European Commission, <i>Maria-Eva Foldes, The Netherlands</i> Consumer views on DTCA advertising, <i>Liset van Dijk, The Netherlands</i> Discussion: The perspective of consumers, <i>Monika Kosinska, EPHA</i> Discussion: The perspective of the industry Representative from the industry</p>
15:45 - 17:15 Room 19	Public health policy	EUPHA and EPHA	<p>6E. Round table: Lost in translation? The need to improve communication between research and policy Chairs: <i>Dineke Zeegers Paget, EUPHA, Natasha Muscat, Malta</i> From Mars and Venus to Lost in translation - introduction, <i>Dineke Zeegers Paget, EUPHA</i> Communication, communication, communication, <i>Monika Kosinska, EPHA</i> Round table discussion, <i>Natasha Muscat, Malta (moderator), Josep Figueras, European Observatory on Health Systems and Policies, José Martin-Moreno, WHO/EURO, Karl Freese, European Commission, Louise Gunning-Schepers, EUSanH, Walter Ricciardi, EUPHA president, Antoine Flahault, ASPHER president</i></p>
15:45 - 17:15 Room 20	Inequalities		<p>6F. Risk factors for psychological stress Chair: <i>Bo Netterstrom, Denmark</i> Cognitive ability in childhood and mortality during 45 years of follow up among Swedish men and women, <i>Tomas Hemmingsson, Sweden</i> Cognitive ability in adolescence associated with subsequent suicide and suicide attempt? How much is explained by psychological distress and personality factors? <i>Alma Sörberg, Sweden</i> Psychological distress among adolescents in Denmark, <i>Björn Holstein, Denmark</i> Parental separation and adult psychological distress: the role of material and relational pathways. Evidence from two British birth cohorts, <i>Rebecca Lacey, United Kingdom</i> Trajectories in the use of psychotropic medication before and after divorce: a register-based study in Finland 1995-2007, <i>Niina Metsä-Simola, Finland</i> Life-course risk factors for mental health problems in the 1987 Finnish Birth Cohort, <i>Mika Gissler, Finland</i></p>
15:45 - 17:15 Room BV1	Sickness absence		<p>6G. Sickness absence and pain Chairs: <i>George Delclos, Spain, Ulla Christensen, Denmark</i> Pain and disability retirement: a follow-up study, <i>Peppiina Saastamoinen, Finland</i> Sickness absence due to musculoskeletal diagnoses and risk of premature death: a nationwide, Swedish, prospective cohort study, <i>Catarina Jansson, Sweden</i> A randomized controlled trial of two different home-based exercise programs in Danish patients on sick-leave due to nonspecific neck and shoulder pain, <i>Nanna Rolving Rasmussen, Denmark</i> Work related psychosocial factors and return to work in sick listed employees with low back pain. A mixed method study, <i>Eva Ladekjær Larsen and Chris Jensen, Denmark</i> Effects of work-related factors on risk of disability pension due to low back diagnoses: a 30-year longitudinal study of Finnish twins, <i>Annina Ropponen, Finland</i> Implementing interorganisational cooperation in labour market reintegration: a case study <i>Christian Ståhl, Sweden</i></p>

TIME/LOCATION	TRACK	ORGANISER	ACTIVITY
15:45 - 17:15 Room BV2	Chronic diseases		<p>6H. Chronic diseases and sickness absence Chairs: <i>Iveta Nagyova, Slovakia, Karsten Thielen, Denmark</i> Interventions to enhance return-to-work for cancer patients: a Cochrane review <i>Angela de Boer, The Netherlands</i> Fatigue and its correlates in cancer patients who had returned to work, <i>Frank van Dijk, The Netherlands</i> Looking beyond return-to-work after cancer: a 5-year longitudinal cohort study among Dutch Post employees, <i>Ute Bültmann, The Netherlands</i> Disability pension after coronary revascularisation. A national follow-up study in Sweden 1994-2003 <i>Katharina Zetterström, Sweden</i> The effect on return to work and absenteeism of a multidisciplinary stress treatment programme <i>Bo Netterström, Denmark</i> Lived experiences of capacity to work while depressed and anxious - a phenomenological study <i>Monica Bertilsson, Sweden</i></p>
15:45 - 17:15 Room B3 M5	Public health research and innovation	EUPHA section Ethics in Public Health	<p>6I. Skills building seminar: Scientific integrity in public health research: what, why, how? Chair: <i>Els Maeckelberghe, The Netherlands</i> 1. Introduction: General Principles and its context (20 minutes) 2. Short discussion of the general principles (15 minutes) 3. Case analysis (40 minutes) 4. Results (15 minutes)</p>
15:45 - 17:15 Room B3 M6	Benefits and reliability of data collection	ECHO project consortium	<p>6K. Round table: ECHO: Dealing with validity and reliability in a performance measurement project Chair: <i>Enrique Bernal-Delgado, Spain</i> ECHO: the project, <i>Enrique Bernal-Delgado, Spain</i> Drawing out the variation attributable to healthcare provider, <i>Karen Bloor, United Kingdom</i> How population flows may affect mapping? <i>Lau Caspar Thygesen, Denmark</i> How much of the totals individual variation is at the area level? A simple multilevel model for reassessing small area variation in aggregated databases, <i>Juan Merlo, Sweden</i></p>
15:45 - 17:15 Room B3 M7	Public health competencies	EUPHA section on Migrant and Ethnic Minority Health	<p>6L. Workshop: Cultural Competences and Ethnic Minorities Chairs: <i>Vincent Lorant, Belgium, Walter Devillé, The Netherlands</i> Chronic Care Management and Culturally Competent Interventions in Type 2 Diabetes Mellitus: Walking together or following two opposite directions? <i>Marie Davrin, Belgium</i> Migrant status and access to health care services in Denmark, <i>Natasja Koitzsch Jensen, Denmark</i> Health status and primary care use by the Roma community in Europe: results of a literature review <i>Diana Pirjol, The Netherlands</i> Getting Access to Culture in Health, <i>Morten Terkildsen (tbc), Denmark</i></p>

TIME/LOCATION	TRACK	ORGANISER	ACTIVITY
15:45 - 17:15 Room B3 M8	All inclusive public health		<p>6M. Use of psychotropic substances Chair: <i>Signe Smith Nielsen, Denmark</i> Social relations, social cohesion and alcohol consumption: Results from a multi-level analysis of the Swiss Health Survey 2007, <i>Christine Fekete, Switzerland</i> Changes in Alcohol Drinking Patterns and their Consequences among Norwegian doctors 2000-2010. A Longitudinal Study based on National Samples, <i>Judith Rosta, Norway</i> International comparison on the consumption of psychoactive substances and driving habits of young people participating in TEN D by Night project, <i>Fabrizio Bert, Italy</i> Psychotropic drugs and accidents in the whole population of Scania, Sweden, <i>Birgit Moden, Sweden</i> Work-family conflict and psychotropic medication: a longitudinal register based study <i>Ossi Rahkonen, Finland</i> Use of psychiatrist and psychologist in relation to mental health status for immigrants, their descendants and ethnic Danes, <i>Signe Smith Nielsen, Denmark</i></p>
15:45 - 17:15 Room B4 M1	News in public health		<p>6N. Genomics matter! Chair: <i>Angela Brand, The Netherlands</i> Genetic and environmental influences on sickness absence: findings from a Swedish twin cohort <i>Pia Svedberg, Sweden</i> Is telomere length a biomarker of aging? <i>Geoff Der, United Kingdom</i> A meta- and pooled analysis of the literature on the association between factor V Leiden, prothrombin G20210A and methylentetrahydrofolate reductase C677T variants, their interaction with lifestyle factors, and risk of venous thromboembolism, <i>Benedetto Simone, Italy</i> A new biological agent for the treatment of Rheumatoid Arthritis: a Health Technology Assessment evaluation, <i>Chiara Cadeddu, Italy</i> Health Technology Assessment of genetic testing for susceptibility to Venous Thromboembolism in Italy, <i>Maria Rosaria Gualano, Italy</i> The Italian Prevention Plan for Public Health Genomics, <i>Stefania Boccia, Italy</i></p>
17:15-18:15 Room B3 M8		EUPHA section on Utilisation of Medicines	AMmed. Annual meeting of the EUPHA section on Utilisation of Medicines
17:15-18:15 Room B3 M6		EUPHA section on Public Health Genomics	Annual meeting of the EUPHA section on Public Health Genomics
17:15-18:15 Room B3 M7		EUPHA section on Public Health Practice and Policy	Annual meeting of the EUPHA section on Public Health Practice and Policy
17:30 - 18:30 AUD. 10-11-12			<p>Plenary 4 Chair: <i>Morten Grønbaek, Denmark</i> Using individually linked population-based registers in research focusing on the inter-relationship between health and welfare. Nordic experiences, <i>Jorn Olsen, Denmark, Camilla Stoltenberg, Norway, Olle Lundberg, Sweden, Elina Hemminki, Finland</i></p>

TIME/LOCATION	TRACK	ORGANISER	ACTIVITY
9:00 - 9:45 AUD. 10-11-12			<p>Plenary 5 Chair: <i>Josep Figueras, WHO</i> Debate on key policy issues around public health training and education, <i>Antoine Flahault, France, Vesna Bjegovic-Mikanovic, Serbia, Kasja Czabanowska, The Netherlands, Stephen Shortell, Unites States</i></p>
Moderated poster sessions			
10:15 - 11:15 Poster Area	Welfare and public health		<p>7A. Welfare and Health Chair: <i>Rikke Lund, Denmark</i> 7A.1 Welfare state typologies, occupational social class, and mental health inequalities: evidence from the 2002 World Health Survey, <i>Nanky Rai, Canada</i> 7A.2 Welfare to work interventions and their effects on health and well-being of lone parents and their children, <i>Marcia Gibson, United Kingdom</i> 7A.3 Equality in health - a road to better health and decreased costs? <i>Inna Feldman, Sweden</i> 7A.4 General health and stress - is there an effect of the economic crisis in Denmark? <i>Lene Hammer-Helmich, Denmark</i> 7A.5 Mortality differentials in disadvantaged areas of Greater Stockholm Area, <i>Bo Burström, Sweden</i></p>
10:15 - 11:15 Poster Area	European public health		<p>7B. Northern European health issues Chair: <i>Christiane Stock, Denmark</i> 7B.1 Dynamics of cross-national poverty and mortality rates, <i>Johan Fritzell, Sweden</i> 7B.2 Genetic and environmental factors affecting sense of coherence in Finland, <i>Karri Silventoinen, Finland</i> 7B.3 Perceived health and aspects of mental wellbeing among residents living near waste treatment centres in Finland, 2006, <i>Marjaleena Aatamila, Finland</i> 7B.4 Household and individual economic position and ill health - a study on direction of causation using prospective register data on a Finnish population sample, <i>Akseli Aittomäki, Finland</i> 7B.5 Seasonal affective disorder and its correlates in Northwest Russia: The Arkhangelsk study <i>Konstantin Serdechnyj, Russia</i> 7B.6 Cutting down deaths by 80% - What really happened to pneumonia mortality in Finland in the 2000s? <i>Kristiina Manderbacka, Finland</i></p>

TIME/LOCATION	TRACK	ORGANISER	ACTIVITY
10:15 - 11:15 Poster Area	Health services and systems		<p>7C. Hospitals Chair: <i>Bodil Bjørnshave, Denmark</i></p> <p>7C.1 Core Competencies to training Infection Control/Hospital Hygiene professionals in Europe <i>Francesco Coiz, Italy</i></p> <p>7C.2 Work experiences and health in a Lithuanian hospital. A Swedish salutogenic approach <i>Göran Ejlertsson, Sweden</i></p> <p>7C.3 Humanisation of an Emergency Department: the experience of an Italian hospital <i>Davide Minniti, Italy</i></p> <p>7C.4 From hospital nursing to health capability; differences in impacting nursing domains perceived by patients in Sweden and Japan, <i>Hideyuki Kobayashi, Japan</i></p> <p>7C.5 Changes in hospital practice and breastfeeding in Lazio region, Italy, <i>Simona Asole, Italy</i></p> <p>7C.6 Hospital preparedness to respond to maxi-emergencies in Italy. Preliminary results <i>Daniela D'Alessandro, Italy</i></p> <p>7C.7 How hospital healthcare management could promptly ensure safety of patients about Legionella risk? A molecular surveillance approach, <i>Nicola Nicolotti, Italy</i></p> <p>7C.8 Hospital care in the process of EU cooperation and integration - a policy transfer perspective <i>Timo Clemens, The Netherlands</i></p> <p>7C.9 Income inequality from the gender perspective in public hospital workers <i>José Luis Navarro Espigares, Spain</i></p>
10:15 - 11:15 Poster Area	Consumers and patients		<p>7D. Poster Workshop: Walk the Talk: A Participatory Approach to Patient Education Chair: <i>Ingrid Willaing, Denmark</i></p> <p>7D.1 The Balancing Man; the Development of a Health Educational Model for Patient Education <i>Ulla Möller Hansen, Denmark</i></p> <p>7D.2 Innovative Health Educational Dialogue Tools; a Way to Enhance Empowerment and Participation, <i>Gitte Englund, Denmark</i></p> <p>7D.3 The Health Educational Juggler; Exploring Needs for Competences in Health Care Professionals, <i>Jane Rohde Voigt, Denmark</i></p>
10:15 - 11:15 Poster Area	Public health policy		<p>7E. Poster workshop: Estimating the burden of communicable diseases in Europe Chairs: <i>Alessandro Cassini, Italy, Mirjam Kretzschmar, The Netherlands</i></p> <p>7E.1 Tackling underreporting: the experience of the Burden of Communicable Diseases in Europe (BCoDE) pilot study, <i>Cheryl Gibbons, United Kingdom</i></p> <p>7E.2 Integrating infectious disease dynamics into further burden of disease assessments - Introducing the concept of transmissible disease burden, <i>Dietrich Plass, Germany</i></p> <p>7E.3 The burden of influenza: evaluation of the Disability Adjusted Life Years (DALYs) and hospital utilization in Italy, <i>Silvia Longhi, Italy</i></p>

TIME/LOCATION	TRACK	ORGANISER	ACTIVITY
10:15 - 11:15 Poster Area	Inequalities		<p>7F. Perinatal health Chair: <i>Laust Mortensen, Denmark</i></p> <p>7F.1 Do Traveller mothers' use of maternity services differ from the general population? Findings from the All Ireland Traveller Birth Cohort Study, <i>Noor an Hamid, Ireland</i></p> <p>7F.2 Pregnant versus non-pregnant women in general practice: a cohort study of differences in diagnoses, prescriptions, referrals, and rates of consultation, <i>Esther Feijen-de Jong, The Netherlands</i></p> <p>7F.3 The implications of father's involvement in pregnancy/labor on the emotional connection with the baby, <i>Manuela Ferreira, Portugal</i></p> <p>7F.4 The impact of socio-demographic factors on low birth weight and preterm birth: A comparative study between Gaza and Brussels, <i>Mazen Abuqamar, Belgium</i></p> <p>7F.5 Analysis of newborns' neonatal deaths due to congenital anomalies correlation with antenatal and neonatal characteristics in Latvia (2000-2007), <i>Irisa Zile, Latvia</i></p> <p>7F.6 The effect of social determinants on recurrent spontaneous abortion in an Italian region (2009) <i>Alessio Gili, Italy</i></p> <p>7F.7 Too many pregnancies end by abortion! <i>Cornelia Rada, Romania</i></p> <p>7F.8 The impact of women's status on utilisation of maternal health services in Eastern European and CIS countries. The cases of Albania, Armenia and Azerbaijan, <i>Daria Ukhova, Russia</i></p>
10:15 - 11:15 Poster Area	Sickness absence		<p>7G. Sickness absence and mental health Chair: <i>Kristina Alexanderson, Sweden</i></p> <p>7G.1 Three-year predictors of paid work in older individuals with depression, osteoarthritis and cardiovascular disease: an investigation into disease-specific and generic predictors <i>Cécile Boot, The Netherlands</i></p> <p>7G.2 Physical and psychological work demands and depressive symptoms in Denmark. Does their match matter for work ability consequences? <i>Karsten Thielen, Denmark</i></p> <p>7G.3 The association of the duration of sickness absence due to adjustment disorders with recurrences among Dutch Post employees, <i>Petra Koopmans, The Netherlands</i></p> <p>7G.4 Sickness absence due to mental diagnoses and risk of premature death: a nationwide, Swedish, prospective cohort study, <i>Linnea Kjeldgård, Sweden</i></p> <p>7G.5 Sociodemographic determinants of recurrent sickness absence due to adjustment disorders among Dutch Post employees, <i>Giny Norder, The Netherlands</i></p> <p>7G.6 Potential predictors of recurrent sickness absence due to depression: a Delphi approach among mental health scientists and professionals, <i>Corne Roelen, The Netherlands</i></p> <p>7G.7 Health, quality of sleep and professional career in female white-collar workers returning to work after long-term sick-listing due to burnout, stress reactions and depression <i>Hélène Sandmark, Sweden</i></p> <p>7G.8 The Risk of Withdrawal from Labor Force in Patients with Schizophrenia in Taiwan <i>Hui-Chih Chang, Taiwan</i></p>

TIME/LOCATION	TRACK	ORGANISER	ACTIVITY
10:15 - 11:15 Poster Area	Chronic diseases		<p>7H. Cancer prevention and care Chair: <i>Kathrine Carlsen, Denmark</i></p> <p>7H.1 A prospective association between quality of life and risk of cancer, <i>Trine Flensburg-Madsen, Denmark</i></p> <p>7H.2 Trends and inequalities in cancer mortality in Scotland, 1974-2009, <i>Carolyn Davies, United Kingdom</i></p> <p>7H.3 Level of education and income as determinants of breast and cervical cancer screening: a meta-analysis, <i>Caterina Bianca Neve Aurora Bianchi, Italy</i></p> <p>7H.4 Epidemiology of and survival from thyroid cancer in the Arkhangelsk region, Russia, 2000-2009, <i>Natalia Glukhareva, Russia</i></p> <p>7H.5 Hepatitis B and C viruses and survival of hepatocellular carcinoma patients in the Arkhangelsk region, Russia, <i>Maria Makarova, Russia</i></p> <p>7H.6 Malignant brain tumors in the Arkhangelsk region, Russia in 2000-2009: a registry-based study, <i>Natalia Glukhareva, Russia</i></p> <p>7H.7 Risk factors for patient delay among breast cancer patients in Estonia, <i>Kaire Innos, Estonia</i></p> <p>7H.8 Pain Management in Emilia Romagna oncology home care patients, <i>Agnese Accorsi, Italy</i></p> <p>7H.9 Knowledge, beliefs and attitudes on cancer and barriers to access services in North African population, <i>Ana Molina-Barceló, Spain</i></p> <p>7H.10 Develop a helpful guide to reading quality information (e-Galic) on health and cancer on the internet, a user manual and content validity, <i>Ana Molina-Barceló, Spain</i></p>
10:15 - 11:15 Poster Area	Public health research and innovation		<p>7I. Infectious diseases - from prevention to preparedness Chair: <i>Ruth Gelletlie, United Kingdom</i></p> <p>7I.1 A study of the prevalence of methicillin-resistant <i>Staphylococcus aureus</i> in swine and nasal carriage in personel working in swine farms in Romania, <i>Alexandru Coman, Romania</i></p> <p>7I.2 Did pandemic preparedness activities aid the response to influenza (H1N1) pandemic in 2009? A qualitative analysis, <i>Ahmed Hashim, United Kingdom</i></p> <p>7I.3 The Greater Manchester Hepatitis C Strategy needs assessments and equity audit of BBV prevention services in Greater Manchester: summary of key findings, <i>Arpana Verma, United Kingdom</i></p> <p>7I.4 Burden of infectious diseases in Germany - preliminary results from the Burden of Communicable Diseases in Europe (BCoDE) pilot study, <i>Dietrich Plass, Germany</i></p> <p>7I.5 PEARL analysis: Decision making on Vaccine policy, <i>Zakhro Djabbarova, Uzbekistan</i></p> <p>7I.6 Cost-Effectiveness of pertussis cocooning vaccination in Europe: a comparative analysis in three countries, <i>Julie Roiz, Belgium</i></p> <p>7I.7 Cost-effectiveness and benefit-cost ratios of adult pneumococcal vaccination in Germany <i>Alexander Kuhlmann, Germany</i></p> <p>7I.8 Factors affecting the uptake of HPV vaccine in North West England, <i>Arpana Verma, United Kingdom</i></p> <p>7I.9 Vaccine Coverage Rates among 12-23 Month Old Children Living in Four Selected Provinces of Turkey: Results of a Lot Quality Survey, <i>Sarp Uner, Turkey</i></p>

TIME/LOCATION	TRACK	ORGANISER	ACTIVITY
10:15 - 11:15 Poster Area	Benefits and reliability of data collection		<p>7K. Methodology Chair: <i>Alastair Leyland, United Kingdom</i></p> <p>7K.1 Analysis of health surveillance systems in Armenia, 2009-2010, <i>Varduhi Petrosyan, Armenia</i></p> <p>7K.2 Models and approaches for quantification of health impacts - preliminary evaluation results <i>Odile Mekel, Germany</i></p> <p>7K.3 Quantitative health assessments for regional and local health policy-making - Adding value by considering their interrelationships, <i>Rainer Fehr, Germany</i></p> <p>7K.4 Quantification in Health Impact Assessment – a case study of commuting by bicycle in Copenhagen, <i>Astrid Ledgaard Holm, Denmark</i></p> <p>7K.5 The application of the Data Envelopment Analysis to evaluate the efficiency in Primary care in Italy, <i>Alessandro Romaniello, Italy</i></p> <p>7K.6 The effectiveness of health appraisal processes currently in addressing health and wellbeing during spatial plan appraisal, <i>Selena Gray, United Kingdom</i></p> <p>7K.7 The proactive assessment of clinical risk with Failure Modes and Effects Analysis (FMEA) is a useful tool for healthcare quality improvement, <i>Francesco Rocco, Italy</i></p> <p>7K.8 Evaluating the co-ordination of services for families and children using structural equation modelling, <i>Johanna Joensuu, Finland</i></p>
10:15 - 11:15 Poster Area	Public health competencies		<p>7L. Media and Health Chair: <i>Mette Aadahl, Denmark</i></p> <p>7L.1 Internet bullying among schoolchildren, <i>Vesna Juresa, Croatia</i></p> <p>7L.2 Internet addiction, mental stress, and sleeping disorders: new public health challenges among university students. A cross-sectional survey in Algeria, France and Hungary, <i>Joel Ladner, France</i></p> <p>7L.3 E-health for a healthy eating and active living strategy, <i>Elena Cabeza, Spain</i></p> <p>7L.4 Role of internet in getting information about health promotion and cancer prevention in Hungary in 2010, <i>Regina Molnar, Hungary</i></p> <p>7L.5 Making health policies more migrant friendly: a case study into the ET.Health, <i>Marie Davurin, Belgium</i></p> <p>7L.6 A study of asthma and allergic rhinitis prevalence, social and economic impact in Bulgaria in 2011 by a Facebook based on-line questionnaire, <i>George Christoff, Bulgaria</i></p> <p>7L.7 Attitude and ranking of websites providing information about the 2010 flu vaccine, <i>Umberto Gelatti, Italy</i></p> <p>7L.8 Occurrence of visually induced sickness symptoms in elementary school children during and after viewing a 3D movie, <i>Angelo Solimini, Italy</i></p>

TIME/LOCATION	TRACK	ORGANISER	ACTIVITY
10:15 - 11:15 Poster Area	All inclusive public health		<p>7M. Work and health 1 Chair: <i>Else Nygaard, Denmark</i></p> <p>7M.1 The implementation of occupational safety and health protection in 28 European welfare states: a multilevel study on variations and possible drivers, <i>Nico Dragano, Germany</i></p> <p>7M.2 Risk assessment of occupational accidents and quality of life among employees in the military industry in Northwest Russia, <i>Alexander Vyazmin, Russia</i></p> <p>7M.3 Regional differences in unemployment and its consequences in Sweden, <i>Lotta Nylén, Sweden</i></p> <p>7M.4 Mental health associates of employment arrangements: a typological approach to employment precariousness, <i>Christophe Vanroelen, Belgium</i></p> <p>7M.5 Work and mental health in Danish eldercare workers, <i>Louise Meinertz, Denmark</i></p> <p>7M.6 The determinants of French GPs' burnout: the impact of the medical practice characteristics <i>Carine Franc, France</i></p> <p>7M.7 Validity of workers' self-reports. Evaluation of a question assessing life-time exposure to occupational physical activity, <i>Anne Moeller, Denmark</i></p>
10:15 - 11:15 Room B4 M1	News in public health		<p>7N. Update on recent changes in society and consequences for health (Late Breaker) Chairs: <i>Torben Jørgensen, Denmark, Julian Mamo, Malta, Helmut Brand, The Netherlands</i></p> <p>Public health nutrition and the CAP: boon or killer! <i>Chis Birt, United Kingdom</i></p> <p>Health and crisis: omens of a greek tragedy, <i>David Stuckler, United Kingdom</i></p> <p>After the Revolution - Reconstructing Health in Libya, <i>Beatrice Riley, Helmut Brand, The Netherlands</i></p> <p>Iodine fortification - only benefit? <i>Charlotte Cerqueira</i></p>
10:15 - 11:15 Poster Area	Migrant and ethnic minority health		<p>7O. Health care for migrants Chair: <i>Charles Aygemang, The Netherlands</i></p> <p>7O.1 Migrants' Access to Primary Health Care and Immunisations in Europe, <i>Martha Pasi, Greece</i></p> <p>7O.2 Inequalities in the access to social and medical care for migrants in three European countries <i>Matthieu Mechain, France</i></p> <p>7O.3 Why do Polish migrants access healthcare in Poland or in Ireland? A qualitative study <i>Gobnait Byrne, Ireland</i></p> <p>7O.4 Providing care to immigrants in long-term mental health services across Europe: considerations for practical reform, <i>Sima Sandhu, United Kingdom</i></p> <p>7O.5 Implementing diabetes courses for immigrants in health care centres in Denmark: a qualitative study of ideals and practices, <i>Nanna Ahlmark, Denmark</i></p> <p>7O.6 Is the immigrant condition associated with low birth weight? <i>Carlos Pereira, Portugal</i></p>

TIME/LOCATION	TRACK	ORGANISER	ACTIVITY
10:15 - 11:15 Poster Area	Child and adolescent public health		<p>7P. Monitoring lifestyle in youth Chair: <i>Pernille Due, Denmark</i></p> <p>7P.1 Food and nutrition in early years childcare settings in England: National, Regional and Local policy and practice in 2010, <i>Helen Buttivant, United Kingdom</i></p> <p>7P.2 The effect of physical activity on concentration of elementary school children. A randomized controlled trial, <i>Christina Kien, Germany</i></p> <p>7P.3 Youth's health behavior among secondary schoolchildren of Mongolia, <i>Enkhmyagmar Dashzeveg, Mongolia</i></p> <p>7P.4 Nutritional Habits among Roma Schoolchildren in Slovakia, <i>Kvetoslava Rimarova, Slovakia</i></p> <p>7P.5 Prevalence of food allergy among Vilnius city primary schools children, <i>Andrius Kavaliunas, Lithuania</i></p> <p>7P.6 Annually repeated monitoring of health behaviour among 15 year old school children as a tool to target health promoting practises at schools in a Danish municipality 2007-2010 <i>Annette Storr-Paulsen, Denmark</i></p> <p>7P.7 Is antisocial behaviour among Roma and non-Roma adolescents in Slovakia related to accidents and injuries prevalence? <i>Peter Kolarcik, Slovakia</i></p> <p>7P.8 Lifestyle health behaviour surveyed in Polish teenagers and parental perception (2011) <i>Piotr Holownia, Poland</i></p> <p>7P.9 Socioeconomic differences in adolescents' breakfast eating, fruit and vegetable consumption and physical activity in Ghana, <i>David Doku, Finland</i></p> <p>7P.10 Sexual behavior and condom use among schoolchildren in Mongolia, <i>Enkhmyagmar Dashzeveg, Mongolia</i></p>
10:15 - 11:15 Poster Area	Lifestyle		<p>7Q. Lifestyle 2 Chair: <i>Tine Tjørnhøj-Thomsen, Denmark</i></p> <p>7Q.1 Inverse association of the obesity predisposing FTO genotype with alcohol consumption and risk of alcohol addiction, <i>Grazyna Broda, Poland</i></p> <p>7Q.2 Integration of quantitative risk assessment in the health impact assessment of the recently aggravated Hungarian anti-smoking policy, <i>Adam Balazs, Hungary</i></p> <p>7Q.3 Does a population-based multi-factorial lifestyle intervention increase social inequality in dietary habits? The Inter99 study. A randomized controlled trial, <i>Ulla Toft, Denmark</i></p> <p>7Q.4 A review of resource utilization of lifestyle interventions for type 2 diabetes prevention among persons with prediabetes, <i>Jens Aagaard-Hansen, Denmark</i></p> <p>7Q.5 Barriers to leisure time physical activity, <i>Noora Sipilä, Finland</i></p> <p>7Q.6 Changes in physical fitness lifestyle health behaviour due to the "Keep Fit" campaign in Poland advocating proper diet and physical exercise (2006-2011), <i>Przemyslaw Bilinski, Poland</i></p> <p>7Q.7 Trends in school-aged children physical activity from 1994 to 2010 in Lithuania <i>Apolinaras Zaborskis, Lithuania</i></p> <p>7Q.8 Efficacy of Group Adaptive Physical exercise programme and Therapeutic Education sessions for patients with stroke: results from a nonrandomized controlled trial, <i>Laura Dallolio, Italy</i></p>

TIME/LOCATION	TRACK	ORGANISER	ACTIVITY
10:15 - 11:15 Poster Area	Health promotion 1		<p>7R. Substance abuse Chair: <i>Svend Sabroe, Denmark</i></p> <p>7R.1 Socioeconomic differences in alcohol and drug use among adolescents, evidence from a developing country, <i>David Doku, Finland</i></p> <p>7R.2 Licit and illicit drug use among female sex workers in bar and club prostitution in Belgium: a quantitative and qualitative study (2009-2010), <i>Karolien van Nunen, Belgium</i></p> <p>7R.3 Oral health of opiate drug abusers under addiction treatment in Tehran, Iran <i>Hajar Shekarchizadeh, Iran</i></p> <p>7R.4 Methadone Maintenance Treatment in Poland 1997-2011, <i>Beata Karakiewicz, Poland</i></p> <p>7R.5 Who is responsible for the prevention of substance use? A cross-national comparison of parental perceptions to prevent adolescents' substance use, <i>Rosalie van der Sar, The Netherlands</i></p> <p>7R.6 Health Stations as user interfaces project: improving the care of citizens with substance abuse problems, <i>Hilkka Heikkila, Finland</i></p> <p>7R.7 A Research Strategy Case Study of Alcohol and Drug Prevention by Non-Governmental Organizations, <i>Charli Eriksson, Sweden</i></p> <p>7R.8 Needs of children of drug abusers in Europe, <i>Ines Aguinaga-Ontoso, Spain</i></p>
10:15 - 11:15 Poster Area	Health promotion 2		<p>7S. Smoking Chair: <i>Astrid Blom, Denmark</i></p> <p>7S.1 National estimates of local smoking prevalence: who to believe? <i>Arpana Verma, United Kingdom</i></p> <p>7S.2 Epidemiology of tobacco use in Greece: results from the Hellas Health III survey (2010) <i>Filippos Filippidis, Greece</i></p> <p>7S.3 23-year trends in socioeconomic inequality in smoking in Denmark: do age and gender matter? <i>Mette Bjerrum Koch, Denmark</i></p> <p>7S.4 Experience of violation/insults during the past three months, social capital and daily smoking: A population-based study, <i>Martin Lindström, Sweden</i></p> <p>7S.5 Smoking as risk factor for disorders of lung function among adult population in Arkhangelsk <i>Elena Andreeva, Russia</i></p> <p>7S.6 Impact of the 2002 Delaware Smoking Ordinance on Heart Attack and Asthma <i>John Moraros, Canada</i></p> <p>7S.7 Implementing smoke-free policy in educational institutions in Armenia, 2009 <i>Diana Petrosyan, Armenia</i></p>

TIME/LOCATION	TRACK	ORGANISER	ACTIVITY
10:15 - 11:15 Poster Area	Public mental health		<p>7T. Violence and mental health Chair: <i>Marie Nørredam, Denmark</i></p> <p>7T.1 How significant is the impact of injury severity on depression? Evidence from a cross-sectional survey, <i>Diana Rus, Romania</i></p> <p>7T.2 Bullying in School Context, <i>Daniela Santos, Portugal</i></p> <p>7T.3 Psycho-social predictors of victimhood from bullying among Israeli school students <i>Keren Dopelt, Israel</i></p> <p>7T.4 The relationship between the traumatic events of childhood and mental illness in Romania <i>Cristian Vladescu, Romania</i></p> <p>7T.5 Mental Health and suicidality of school children in Mongolia, <i>Enkhmyagmar Dashzeveg, Mongolia</i></p> <p>7T.6 Violence against women in Russia: summary of the existing evidence, <i>Anna Subbotina, Russia</i></p> <p>7T.7 Socio-economic factors influencing domestic violence in Romania <i>Ileana Manoela Prejbeanu, Romania</i></p> <p>7T.8 Design and Participation in Parents Together, a longitudinal intervention study of a parental support program, <i>Madelene Larsson, Sweden</i></p>
10:15 - 11:15 Poster Area	Interesting health posters		<p>7U. Self-rated health and quality of life Chair: <i>Anna Paldam Folker, Denmark</i></p> <p>7U.1 A multilevel analysis of the influence of social cohesion on self-rated health in thirty countries <i>Ying-Chih Chuang, Taiwan</i></p> <p>7U.2 Predictors of poor self-rated health in Armenia, 2006, <i>Anahit Demirchyan, Armenia</i></p> <p>7U.3 Self-rated health and risk-taking behavior inequalities among ethnic majority and minority population groups of school-aged children in Lithuania, <i>Linas Sumskas, Lithuania</i></p> <p>7U.4 Self-rated health, ethnicity and social position in a deprived neighbourhood in Denmark <i>Pernille Tanggaard Andersen, Denmark</i></p> <p>7U.5 Beyond the "self" in diabetes care: What are the tools and what are the effects? <i>Nete Schwennesen, Denmark</i></p> <p>7U.6 Comparison of health-related quality of life between type 1 diabetes girls and boys using child self-report and parent proxy-report, <i>Andrea Lukács, Hungary</i></p> <p>7U.7 Fatigue and psychological distress in rheumatoid arthritis: the mediation effect of adjustment to disease, <i>Iveta Nagyova, Slovakia</i></p> <p>7U.8 Self-reported quality of life among patients living with ischaemic heart disease in Scandinavia <i>Tina Birgitte Hansen, Denmark</i></p> <p>7U.9 Coping self-efficacy and neuroticism as explanatory variables of anxiety at early and established stages of rheumatoid arthritis, <i>Iveta Nagyova, Slovakia</i></p>

TIME/LOCATION	TRACK	ORGANISER	ACTIVITY
Oral sessions			
11:30 - 13:00 AUD. 10-11-12	Welfare and public health		<p>8A. Socio-economic determinants of health Chair: <i>Pernille Tanggaard Andersen, Denmark, Ane Bonnerup Vind, Denmark</i> Changes in economic difficulties as determinants of health related functioning <i>Eero Lahelma, Finland</i> Quality of life and socioeconomic status among the Lithuanian urban population <i>Regina Reklaitiene, Lithuania</i> Participation in mammography screening among migrants and non-migrants: do household size, socioeconomic position, and use of other healthcare services explain the differences? <i>Maria Kristiansen, Denmark</i> Socioeconomic and clinical factors associated with the use of lipid-lowering medication among patients with diabetes, <i>Tuulikki Vehko, Finland</i> Economic difficulties and subsequent sleep problems: evidence from British and Finnish occupational cohorts, <i>Tea Lallukka, Finland</i> Socio-economic differences in self-reported insomnia and stress in Finland from 1979 to 2002 <i>Kirsi Talala, Finland</i></p>
11:30 - 13:00 Room 16	European public health	EUPHA Research	<p>8B. Workshop: The political economy of health research in Europe Chair: <i>Chris Birt, United Kingdom</i> Building support for health research in Europe, <i>Mark McCarthy, United Kingdom</i> Civil society and social innovation for public health, <i>Cláudia Conceição, Portugal</i> Linking food and health in European research policy, <i>Kirsten Dressel, Germany</i> From project to evidence - the difficult path at European level, <i>Margaritha Voss, Sweden</i></p>
11:30 - 13:00 Room 17	Health services and systems	EUPHA Section of Public Health Economics	<p>8C. Workshop: Equity in delivering and funding health systems Chair: <i>Beatriz Gonzalez Lopez-Valcarcel, Spain</i> Advances and approaches to reduce health inequalities in Europe, <i>José M Martin-Moreno, WHO Europe</i> Monitoring equity in Europe: evidence and suggestions for further research <i>Rosa Maria Urbanos-Garrido, Spain</i> Out of pocket payments and impoverishment: an analysis at the household level in Turkey <i>Nesrin Cilingiroglu, Turkey</i> Measuring the importance of efficiency in the equity-efficiency trade-off in health care decision making, <i>Jeff Richardson, Australia</i> Priority setting between elective surgery interventions with waiting lists in Spain: criteria, weights and ranking of interventions, <i>Paula Adam, Spain</i></p>

TIME/LOCATION	TRACK	ORGANISER	ACTIVITY
11:30 - 13:00 Room 18	Consumers and patients		<p>8D. Health literacy Chairs: <i>Allan Linneberg, Denmark, Finn Diderichsen, Denmark</i> Media and politics: Empirical data on their cross-influence in health policy, <i>Damien Contandriopoulos, Canada</i> Public deliberation about ethical values and the AH1N1 vaccination campaign in Quebec, Canada <i>Raymond Masse, Canada</i> Rigidity in informed consent may hinder health services research - interviews of ethics committee Chairs in Finland, <i>Elina Hemminki, Finland</i> Health Literacy Survey among Elderly People in Kosovo, <i>Ervin Toci, Albania</i> Developing medicines adherence policy for Europe: The Ascertainning Barriers to Compliance (ABC) Project Delphi Study, <i>Wendy Clyne, United Kingdom</i> Knowledge and risk perception about electromagnetic fields in general practitioners in Germany <i>Gabriele Berg-Beckhoff, Denmark</i></p>
11:30 - 13:00 Room 19	Public health policy		<p>8E. Does policy make you healthier? Chairs: <i>Natasha Muscat, Malta, Signild Vallgård, Denmark</i> Challenges and facilitators for intersectoral health policy in a Danish municipality <i>Maja Larsen, Denmark</i> Neighbourhood deprivation and health behaviour in the Capital Region of Denmark <i>Kirstine Robinson, Denmark</i> Promotion of physical activity or reduction of sedentary behaviour - should we address both types of behaviours in future public health recommendations? <i>Mette Aadahl, Denmark</i> What motivates children to be physically active? A systematic review of reviews and meta-analysis <i>Elena Sterdt, Germany</i> Improving cross-national physical activity information in Europe. Design and manual of a new international physical activity questionnaire, <i>Jonas Finger, Germany</i> The Use of Evidence by Public Health Policymakers, <i>Srinivasa Katikireddi, United Kingdom</i></p>
11:30 - 13:00 Room 20	Inequalities	European Observatory on Health Systems and Policies and EUPHA Section on Migrant and Ethnic Minority Health	<p>8F. Workshop: Migration and health in the European Union Chairs: <i>Bernd Rechel, United Kingdom, Walter Devillé, The Netherlands</i> Differences between migrants and locally born European populations in the risk of non-communicable diseases, <i>Anton Kunst, The Netherlands</i> Communicable disease among migrants and screening policies in Europe, <i>T Wörmann, Germany</i> Mental health of refugees and asylum-seekers, <i>Jutta Lindert, Germany</i> Occupational health in migrant workers in Europe, <i>E Ronda, Spain</i></p>

TIME/LOCATION	TRACK	ORGANISER	ACTIVITY
11:30 - 13:00 Room BV1	Sickness absence	National Research Centre for the Working Environment, Copenhagen, Denmark	<p>8G. Round table: Innovative approaches in return-to-work intervention research Chairs: <i>Ute Bültmann, The Netherlands, Maj Britt Dahl Nielsen, Denmark</i> Using process evaluations to explain unexpected results of return to work interventions <i>Marie Martin, Denmark</i> Implementation of a national coordinated and multidisciplinary return-to-work program <i>Birgit Aust, Denmark</i> Sustainable return to work: A new approach to prevent recurrent sick leave, <i>Iris Arends, The Netherlands</i> Return to work interventions for employees with common mental disorders: the role of self-efficacy <i>Jenny Huijs, The Netherlands</i></p>
11:30 - 13:00 Room BV2	Chronic diseases		<p>8H. Social inequalities in chronic diseases Chairs: <i>Iveta Nagyova, Slovakia, Naja Hulvej Rod, Denmark</i> The changing relationship between income and mortality in Finland 1988-2007 <i>Lasse Tarkiainen, Finland</i> Excess mortality of depression in Finland in 1998-2007 - variation according to cause of death and social factors, <i>Heta Moustgaard, Finland</i> Socioeconomic status is inversely related to prognosis after acute myocardial infarction, especially in men: results from a Dutch nationwide study, <i>Louise van Oeffelen, The Netherlands</i> The burden of type 2 diabetes attributable to lower educational levels in Sweden <i>Emilie Agardh, Sweden</i> Socioeconomic position and change in purchase of prescribed painkillers after hysterectomy on benign indication, <i>Signe Daugbjerg, Denmark</i> Childhood adversity as a risk for cancer. Findings from the 1958 British Birth Cohort Study <i>Michelle Kelly-Irving, France</i></p>
11:30 - 13:00 Room B3 M5	Public health research and innovation		<p>8I. Methodological challenges Chair: <i>Giuseppe la Torre, Italy</i> Comparison of computer-assisted personal interviewing and self-administered questionnaires: Effect on representativeness and health indicators. Denmark 2010, <i>Anne Illemann Christensen, Denmark</i> Scraping the Barrel: An experiment in wording final reminders for surveys <i>Peter Donnelly, United Kingdom</i> Creating health and wellbeing indicators for Glasgow, <i>Bruce Whyte, United Kingdom</i> Measuring socioeconomic inequity in health care, <i>Sonja Lumme, Finland</i> Comparison of Bayesian and non-Bayesian methods to estimate the standardised mortality ratio exemplified by death due to lung cancer, <i>Annette Ersbøll, Denmark</i></p>

TIME/LOCATION	TRACK	ORGANISER	ACTIVITY
11:30 - 13:00 Room B3 M6	Benefits and reliability of data collection		<p>8K. Benefits of surveillance</p> <p>Chairs: <i>Marieke Verschuuren, The Netherlands, Annette Ersbøll, Denmark</i></p> <p>Interactive atlases of health and socially determined health inequalities at sub national level in Europe based on publicly available EUROSTAT data, <i>Ivo Rakovac, WHO Europe</i></p> <p>Mortality among Status Aboriginals in Alberta, Canada, 2000-2008, <i>Larry Svenson, Canada</i></p> <p>The performance of mandatory and sentinel surveillance systems for communicable diseases: lessons to learn from the Italian experience, <i>Chiara de Waure, Italy</i></p> <p>Population based registers as a source for post-approval drug research: a case study on antipsychotics use in Finland, <i>Pasi Korhonen, Finland</i></p> <p>Evaluation of the European syndromic surveillance approach SIDARTha <i>Alexandra Ziemann, Germany</i></p> <p>Monitoring patient safety during generalized introduction of DRGs for hospital reimbursement in Switzerland, <i>Jean-Marie Januel, Switzerland</i></p>
11:30 - 13:00 Room B3 M7	Public health competencies	ASPHER Working Group on Public Health Advocacy and Communication (in collaboration with ECDC)	<p>8L. Workshop: Application of e-tools in public health capacity strengthening: training, advocacy and communication</p> <p>Chairs: <i>Alena Petrakova, ECDC, Helmut Brand, The Netherlands, Karl Ekdahl, ECDC</i></p> <p>Field Epidemiology Manual wiki (FEM wiki), <i>Vladimir Prikazsky, ECDC</i></p> <p>ASPHER online resource centre for public health education & training, <i>Robert Otok, ASPHER</i></p> <p>EUPHApedia - Building knowledge and capacity together, <i>Dineke Zeegers Paget, EUPHA</i></p> <p>Follow up discussion facilitated by Helmut Brand and Karl Ekdahl</p>
11:30 - 13:00 Room B3 M8	All inclusive public health		<p>8M. Work and Health 2</p> <p>Chairs: <i>Karsten Thielen, Denmark, Claus Vinther Nielsen, Denmark</i></p> <p>Long term trends in local labour markets and health: evidence from England <i>Mylene Riva, United Kingdom</i></p> <p>The contribution of health professionals to the genesis of occupational health standards: the impact of the code of ethic in case of asbestos in The Netherlands, <i>Nico Plomp, The Netherlands</i></p> <p>Violence at work and psychotropics-use, <i>Ida E. H. Madsen, Denmark</i></p> <p>Burnout within the Nursing Profession in North of Portugal at 2009, <i>Conceicao Rainho, Portugal</i></p> <p>Farm Work Exposure of Older Male Farmers in Saskatchewan, <i>Don Voaklander, Canada</i></p> <p>Multiple roles, health and sickness absence? A five year follow-up study on women in Sweden <i>Carin Stalan Nyman, Sweden</i></p>

TIME/LOCATION	TRACK	ORGANISER	ACTIVITY
11:30 - 13:00 Room B4 M1	News in public health		<p>8N. Ferenc Bojan Young Investigators award Chairs: <i>Torben Jørgensen, Denmark, Julian Mamo, Malta</i> Panel of judges: <i>Julian Mamo, Malta, Helmut Brand, The Netherlands, Arja Aro, Denmark, Torben Jørgensen, Denmark</i> A 26-year Finnish follow-up study on adult outcomes of binge drinking trajectories from adolescence to middle age, <i>Noora Berg, Finland</i> The association of occupational social class with subsequent disability retirement: the contribution of health behaviours and working conditions, <i>Taina Leinonen, Finland</i> The role of work-related factors on early retirement in 11 European countries, <i>Suzan Robroek, The Netherlands</i> Alcohol drinking and disability retirement - a follow-up study among middle-aged employees <i>Aino Salonsalmi, Finland</i> Culturally Competent Interventions in Type 2 Diabetes Mellitus Management A way to decrease health inequalities among ethnic minority groups? A systematic literature review <i>Marie Davurin, Belgium</i> The relationship between neighbourhood resources and the risk of poor self-rated health: a hierarchical event history analysis, <i>Sven Voigtländer, Germany</i></p>
14:00- 14:30 AUD 10-11-12			<p>Plenary 6 Chair: <i>Finn Kamper-Jørgensen, Denmark</i> The Danish "Flexicurity model" for labour market policy and social policy <i>Mogens Lykketoft, Member of Parliament, Denmark</i></p>
14:30 - 15:15 AUD. 10-11-12			<p>Closing ceremony Chair: <i>Finn Kamper-Jørgensen, Denmark</i> Award ceremony - Best abstract prize 2011 - Best poster prize 2011 - Ferenc Bojan Young Investigator award The Danish Society of Public Health prize will be awarded to a European Public Health person, with a summary of the conference by the prize winner. Invitation to Malta 2012</p>

ANNUAL MEETINGS

All 18 EUPHA sections and the two new proposed sections are organising annual meetings during Copenhagen 2011.

Meetings of the following sections are planned for:

THURSDAY, 10TH NOVEMBER 2011

Public Health Epidemiology	Room BV2	15:30 - 16:15
Chronic Diseases	Room 16	16:00 - 17:00
Food and Nutrition	Room 17	16.00 - 17.00
Health Promotion	Room 18	16:00 - 17:00
Injury Prevention and Safety Promotion	Room 19	16:00 - 17:00
Migrant and Ethnic Minority Health	Room 20	16:00 - 17:00

FRIDAY, 11TH NOVEMBER 2011

Environment Related Disease	Room 17	11:45 - 12:30
Public Health Monitoring and Reporting	Room 18	11:45 - 12:30
Public Health Economics	Room 19	11:45 - 12:30
Public Mental Health	Room 20	11:45 - 12:30
Social Security and Health	Room BV 1	11:45 - 12:30
Urban Public Health	Room BV 2	11:45 - 12:30
Infectious Disease Control	Room B3 M6	11.45 - 12.30
Proposed Section on Health Impact Assessment	Room B3 M8	11:45 - 12:30
Child and Adolescent Public Health	Room B3 M5	12:30 - 13:30
Ethics in Public Health	Room B3 M6	12:30 - 13:30
Health Services Research	Room B3 M7	12:30 - 13:30
Utilisation of Medicines	Room B3 M8	17:15 - 18:15
Public Health Genomics	Room B3 M6	17:15 - 18:15
Public Health Practice and Policy	Room B3 M7	17:15 - 18:15

GENERAL INFORMATION

CONFERENCE INFORMATION FROM A-Z

Abstract book

Abstracts of all presentations in the scientific programme are published in the supplement of the European Journal of Public Health. You will find a copy in your conference bag.

ATM

Withdrawal of money is possible in the West Hall next to the reception.

Catering

Lunch and coffee is served in the exhibition area.

Cloak room

There will be a guarded cloakroom available on Thursday and Saturday. Cloakroom on Friday the wardrobe will be on your own responsibility.

Evaluation

We kindly ask you to fill in the online evaluation form – during the conference or after the conference via the website www.eupha.org

First aid and emergency service

A first aid officer will be available in the Conference Centre. Please ask the staff for help. Number for police – ambulance - fire brigade: Dial 112

Internet

Wireless internet is available free of charge in the entrance areas, in the foyer below the auditoria, in the exhibition area and on the 1st floor. The network is called BC-Guest, is open and requires no password. Kindly provided by EUPHA and ASPHER.

Local Transportation

The Bella Center has its own Metro Station called "Bella Center". It will take you 12 min. from the city centre. Please note that there is no metro stop at the Central Station. Please use the station called "Nørreport" instead. A map of the metro lines can be found on www.m.dk

Posters

The poster exhibition can be found in the B-halls on the ground floor. The moderated poster sessions will take place in the poster area. Please put up your poster at the poster boards assigned to you using the special tape provided in the hall. Posters should be removed from the boards from 14.00 on Saturday 11 November.

Registration/Hospitality desk - opening hours during the conference

Wednesday, 9 November	07.30-17.00
Thursday, 10 November	07.30-17.00
Friday, 11 November	08.30-17.00
Saturday, 12 November	08.30-14.00

Smoking

The European Public Health Conference is a non-smoking conference. Please move away from the entrance when smoking.

Speakers pre-view room

Speakers shall hand in their presentation to the technician in the morning of their presentation. The pre-view room is in BV 3 on the 1st floor.

Staff

You will recognize our staff by their green t-shirts with the text ASK ME.



SOCIAL PROGRAMME



WELCOME RECEPTION, THURSDAY, 10 NOVEMBER

There are two receptions: one at the City Hall and one in the Bella Centre. It is not possible to attend both. The welcome reception at the City Hall starts at 19.30 and is limited to 600 delegates. The welcome reception in the Bella Center starts at 18.45.

The delegates choose which reception they wish to attend when they register at the registration desk.

Dress: informal



CONFERENCE DINNER, FRIDAY, 11 NOVEMBER 19.30

We are happy to invite you to the conference dinner at Øksnehallen on Friday 11.11.11. Øksnehallen is a unique hall in the old Meat Packing District in the centre of Copenhagen. A great evening with good food and wine awaits you.

A limited number of dinner tickets will also be available at the registration desk on-site for the price of € 60.

Øksnehallen, Halmtorvet 11, 1700 Copenhagen, is situated just 5 min. walk from the central station.

Dress: informal

EXHIBITION FAIR

**The following organisations are presenting themselves at the exhibition fair.
Exhibitors are grouped on the basis of the nature of their activities.**

ORGANISERS

- European Public Health Association (EUPHA) (17)
- Association of Schools of Public Health in the European Union (ASPHER) (16)
- Danish National Institute of Public Health (14)
- Research Centre for Prevention and Health, Denmark (RCPH) (15)

HEALTH POLICY FAIR

- Netherlands Institute for Health Services Research (NIVEL) (10)
- French School of Public Health (9)
- European Science Advisory Network for Health (EuSANH) (7)
- European Commission (3A)
- European Observatory on Health Systems (11)
- European Centre for Diseases Control (2)
- National Board of Health Denmark (3)
- Nordic Council of Ministres (4)
- WHO Regional Office for Europe (5)
- Danish Regions (18)

JOURNAL / PUBLISHER FAIR

- Routledge - Taylor & Francis (12)
- Oxford University Press (OUP) (13)
- Sage publishers (SAGE) (6)
- Springer-Verlag GmbH (8)
- BioMed Central (1)

OPENING HOURS

November 10 13:00 – 18:00

November 11 08:30 – 17:00

November 12 08:30 – 14:00

INTERNATIONAL SCIENTIFIC COMMITTEE

Torben Jørgensen, Denmark (chair)
Niek Klazinga, Netherlands (past chair)
Julian Mamo, Malta (future chair)
Diana Delnoij, EUPHA
Antoine Flahault, ASPHER
Genc Burazeri, Albania
Horst Noack, Austria
Antoon De Schryver, Belgium
Izet Masic, Bosnia and Herzegovina
Luka Kovacic, Croatia
Ilona Koupil, Czech Republic
Finn Diderichsen, Denmark
Jaakko Kaprio, Finland
Thierry Lang, France
Péter Józán, Hungary
Lilja Jónsdóttir, Iceland
Guiseppe La Torre, Italy
Girts Brigis, Latvia
Ramune Kalediene, Lithuania
Stanislaw Tarkowski, Poland
Carlos Matias Dias, Portugal
Silvia Florescu, Romania
Andrej Demine, Russia
Snezana Ukropina, Serbia
Iveta Rajnicova-Nagyova, Slovakia
Tit Albreht, Slovenia
M. Luisa Vázquez Navarrete, Spain
Urban Janlert, Sweden
Nicole Probst-Hensch, Switzerland
Clare Jinks, United Kingdom
Presidents of EUPHA sections

LOCAL MEMBERS OF THE ISC 2011

Torben Jørgensen
Charlotte Glümer
Finn Kamper-Jørgensen
Inge-Lise Andersen
Mette Kjølby
Lau Caspar Thygesen
Finn Diderichsen
Naja Hulvej Rod

INTERNATIONAL CONFERENCE COUNCIL

Finn Kamper-Jørgensen, chair
Niek Klazinga (past chair)
Julian Mamo (future chair)
Walter Ricciardi
Antoine Flahault
Dineke Zeegers Paget
Dorli Kahr-Gottlieb
Robert Otok

LOCAL ORGANISING COMMITTEE

Finn Kamper-Jørgensen, chair
Torben Jørgensen
Charlotte Glümer
Mette Kjølby
Kirsten Vinther-Larsen
Ulrik Steen
Ida Husby
Maja Jensen
Jens Krogh
Pia Assenholm
Finn Diderichsen
Morten Ørsted-Rasmussen

LOCAL SECRETARIAT

Birgitte Pickering
Ole Refstrup
Pia Skovsen
Jonna Refstrup

CONFERENCE SECRETARIAT

Dorli Kahr-Gottlieb
Dineke Zeegers Paget
Birgit Ruess

ORGANISERS, SPONSORS AND ECONOMIC SUPPORT

ORGANISED BY

- Danish Society of Public Health
- EUPHA
- ASPHER



Danish Society of Public Health



IN COLLABORATION WITH

- National Institute of Public Health, University of Southern Denmark
- Research Centre for Prevention and Health, Denmark
- Capital Region of Denmark
- University of Southern Denmark
- European Commission
- Ministry of Health and Prevention, Denmark



RESEARCH CENTRE FOR
PREVENTION AND HEALTH



The Capital Region
of Denmark



UNIVERSITY OF SOUTHERN DENMARK

SPONSORS AND ECONOMIC SUPPORT:

- European Commission
- Ministry of Health and Prevention, Denmark
- Trygfonden
- Nordeafonden
- Open Society Institute
- SAS
- Sanofi Pasteur MSD
- ECDC
- National Board of Health



TrygFonden
kystlivredning

NORDEA
FONDEN



sanofi pasteur MSD
vaccines for life

Sundhedsstyrelsen
National Board of Health



BRIDGE PHOTOGRAPHERS:

Henrik Lange – Highways.dk: Track E-F-K-L-M-N-O-P-Q-R-S-T-U

Pierre Mens – Öresundsbron: Track A

Henrik Als Nielsen: Track B

Peder Palshøj Pedersen: Track C-G-I

Heidi Karlsen www.langeland.dk: Track D

Ole Refstrup: Track H

OVERVIEW OF BELLA CENTER

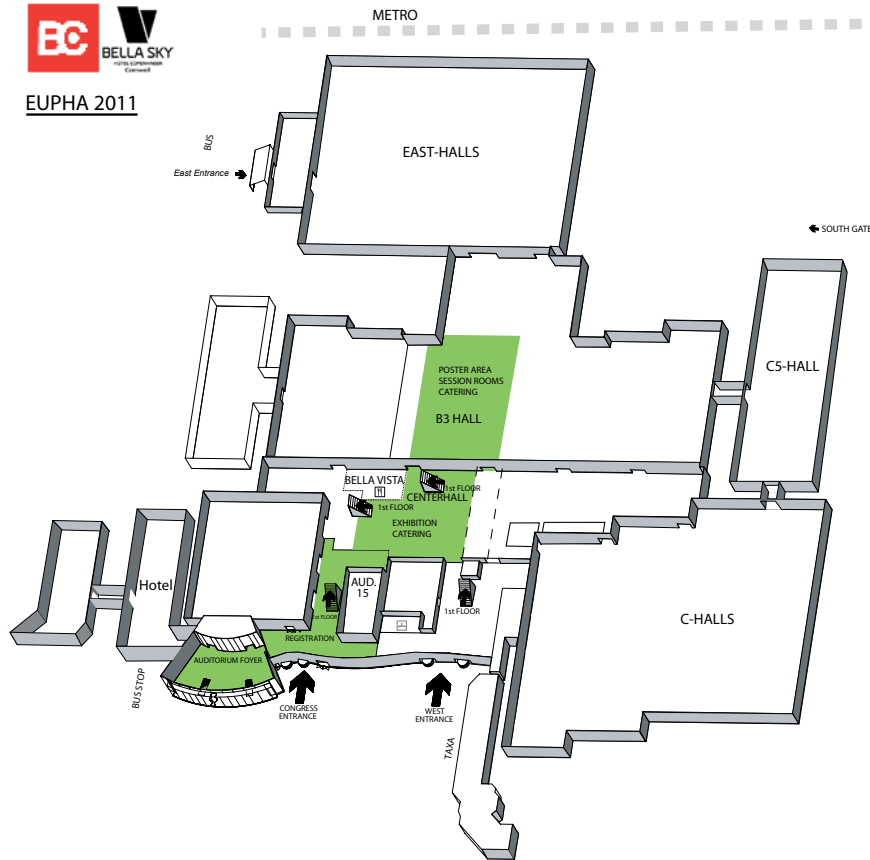

MEETING ROOM

Aud 10-12	Plenary room	Meeting room 19	Session room	Meeting room B3 M5 Session room
	Session room	Meeting room 20	Session room	Meeting room B3 M6 Session room
Meeting room 16	Session room	Meeting room BV 1	Session room	Meeting room B3 M7 Session room
Meeting room 17	Session room	Meeting room BV 2	Session room	Meeting room B3 M8 Session room
Meeting room 18	Session room	Meeting room BV 3	Speaker preview	Meeting room B4 M1 Session room

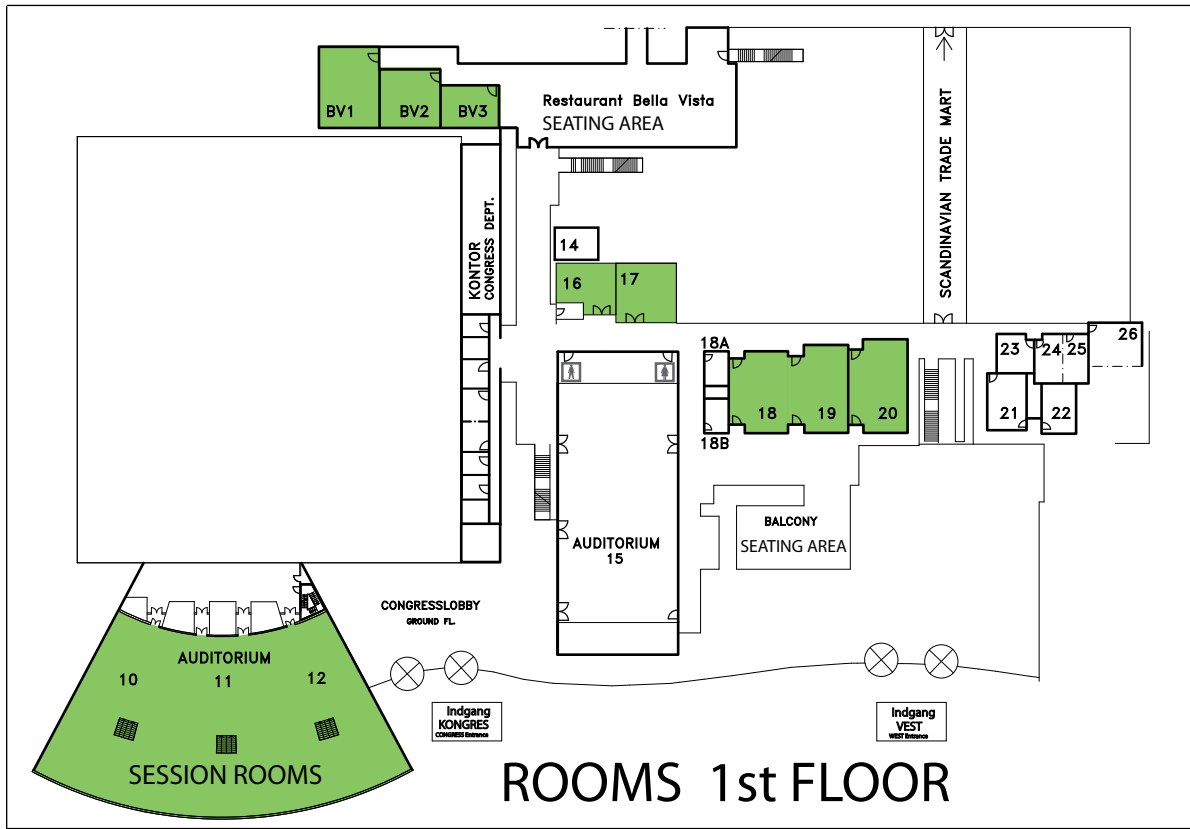

OVERVIEW OF COPENHAGEN

